

InBody970s

User's Manual **USA**

Intended Use

The device should be used as an adjunct for clinical decision making and is not intended to diagnose or treat any diseases.

InBody User's Manual for Measurement Guide and Setup

Thank you for purchasing the InBody.
This user's manual describes all the features of the InBody.
Please read before use and keep it in a safe place.
By following the manual instructions,
you will be able to use the InBody more safely and effectively.

Headquarters Information InBody

(주)인바디 본사 [대한민국]
06106 서울시 강남구 언주로625 인바디빌딩
TEL: 02-501-3939 FAX: 02-6919-2417 고객센터: 1899-5841
Website: inbody.com E-mail: info@inbody.com

InBody Co., Ltd. [HQ]
InBody Bldg., 625, Eonju-ro, Gangnam-gu, Seoul 06106 KOREA
TEL: +82-2-501-3939 FAX: +82-2-6919-2417
Website: inbody.com E-mail: info@inbody.com

(주)인바디
31025 충청남도 천안시 서북구 입장면 흑암길 15
TEL: 041-581-3003 FAX: 041-581-3103
Website: inbody.com E-mail: info@inbody.com

InBody Co., Ltd. [MANUFACTURER]
15, Heugam-gil, Ipjang-myeon, Seobuk-gu, Cheonan-si,
Chungcheongnam-do 31025 KOREA
TEL: +82-41-581-3003 FAX: +82-41-581-3103
Website: inbody.com E-mail: info@inbody.com

Representative & Sponsor Information

InBody Europe B.V. [NETHERLANDS]
Gyroscoopweg 122, 1042 AZ, Amsterdam, The Netherlands
TEL: +31-20-238-6080 FAX: +31-6-5734-1858
Website: nl.inbody.com E-mail: info.eu@inbody.com
Website (CS): csinbody.eu E-mail (CS): support@inbody.com

InBody Europe B.V. Niederlassung Deutschland [GERMANY]
Mergenthalerallee 15-21, 65760 Eschborn, Germany
TEL: +49-6196-76-916-62 FAX: +49-6196-76-916-11
Website: de.inbody.com E-mail: erfolg@inbody.com

InBody UK [UNITED KINGDOM]
Orega, Belmont Road, Uxbridge, UB8 1HE, United Kingdom
TEL: +44-1530-569620
Website: uk.inbody.com E-mail: uk@inbody.com

InBody Oceania [AUSTRALIA]
Main office: Level 8, 1 York Street, SYDNEY, NSW 2000, Australia
Showroom: U2/82-86 Minnie Street, Southport, Queensland
TEL: +61-7-5681-1900
Website: au.inbody.com Email: oceania@inbody.com

InBody USA [USA]
13850 Cerritos Corporate Dr. Unit C Cerritos, CA 90703 USA
TEL: +1-323-932-6503 FAX: +1-323-952-5009
Website: inbodyusa.com E-mail: info.us@inbody.com

InBody BWA Inc. [USA]
2550 Eisenhower Avenue, Suite C 209, Audubon, PA 19403
TEL: +1-610-348-7745
Website: inbodybwa.com E-mail: bwainquiries@inbody.com

株式会社インボディ・ジャパン [JAPAN]
〒136-0071 東京都江東区亀戸1-28-6 タニビル
TEL: 03-5875-5780 FAX: 03-5875-5781
Website: inbody.co.jp E-mail: inbody@inbody.co.jp

拜斯倍斯医疗器械贸易（上海）有限公司 [代理人及售后服务] [CHINA]
上海市闵行区虹莘路3999号上海万象城MT2写字楼306b-308室
电话: +86-21-6443-9705 传真: +86-21-6443-9706
网站: inbodychina.com 电子邮箱: info@inbodychina.com

InBody Asia [MALAYSIA & SINGAPORE]
Unit 3A-11, Oval Damansara, 685 Jalan Damansara Kuala Lumpur,
WP KL 60000 Malaysia
TEL: +60-3-7732-0790 FAX: +60-3-7733-0790
Website: inbodyasia.com E-mail: info@inbodyasia.com

Biospace Latin America [MÉXICO]
Insurgentes Sur 1457, Piso 15 Int.2. Col. Insurgentes Mixcoac,
Alcaldia Benito Juarez, C.P. 03920, Ciudad de México, México
TEL: +52-55-5025-0147
Website: inbodymexico.com E-mail: info.mx@inbody.com

InBody India [INDIA]
57/57 A, 1st Floor, Raj Industrial Complex, Military Road, Marol,
Andheri (East), Mumbai- 400059, Maharashtra, India
TEL: +91-22-6223-1911
Website: inbody.in E-mail: india@inbody.com

Copyright

Reproduction, adaptation, or translation of this manual is prohibited without prior written consent from InBody Co., Ltd. under the copyright laws. This manual may be printed incorrectly and subject to change without notice. InBody Co., Ltd. shall not be liable for any errors, incidental, or consequential damages that occurred by not complying with the content of the User's Manual. Visit our website (inbody.com) to view and download additional information about the InBody.

InBody Co., Ltd. reserves the right to modify the appearance, specifications, etc. of this product to improve its quality, without prior notice.

©2025 InBody Co., Ltd. All rights reserved.

Table of Contents

1	Safety.....	4	6	InBody Test.....	19
1.1	Safety Symbols Used in the User's Manual.....	4	6.1	Precautions for Test	19
1.2	Precautions for Use.....	4	6.2	Test Instructions	19
2	Device Overview.....	6	6.3	Test Posture	22
2.1	Unpacking	6	7	Maintenance and Storage	23
2.2	Device Components	6	7.1	Precautions for Maintenance	23
2.3	Name of Each Part	7	7.2	Cleaning.....	23
3	Installation.....	9	7.3	Disinfecting	23
3.1	Installation Environment.....	9	7.4	Repacking and Transportation	24
3.2	Installation	9	7.5	Storage Environment.....	24
4	Setting	12	8	Frequently Asked Questions (FAQ) ..	25
4.1	Initial Setup	12	8.1	Regarding the Device.....	25
5	Connecting Compatible Device	15	8.2	Regarding the InBody Test.....	26
5.1	Printer	15	9	Classifications and Specifications....	27
5.2	Stadiometer	15	9.1	Classifications	27
5.3	Blood Pressure Monitor	15	9.2	Specifications	27
5.4	Barcode Reader	15	9.3	Symbols Used on the Device.....	30
5.5	LookinBody	16	9.4	Guidance and Manufacturer's Declaration.....	32
5.6	Connecting Bluetooth.....	16			
5.7	Connecting Internet.....	17			

1 Safety

1.1 Safety Symbols Used in the User's Manual

Warning

Failure to comply with safety warnings and regulations can cause serious injury or death.

Caution

Failure to comply with safety cautions and regulations can cause injury or property damage.

Note

LookinBody applies the same as LookinBody120.

Avertissement

Le non-respect des consignes de sécurité et des règlements peut causer des blessures graves ou la mort.

Attention

Le non-respect des consignes de sécurité et des règlements peut causer des blessures ou des dommages matériels.

Note

LookinBody s'applique de la même manière que LookinBody120.

1.2 Precautions for Use

Warning

- Individuals with medical implant devices such as pacemakers, or essential support devices such as patient monitoring systems, must not use this device. Although the micro alternative currents flowing through the body during the test are relatively safe, they can potentially cause external devices to malfunction, which can endanger lives. InBody Co., Ltd. shall not be liable for any damages to an individual or an equipment that occurred by not complying with the content above.
- The Bioelectrical Impedance Analysis (BIA) method does not harm the human body because it uses micro alternative currents. However, if you are pregnant, please consult your doctor or specialist.
- Individuals with a contagious or infectious disease are not recommended to use the device. If an individual with any kind of contagious disease or infection tests on the InBody, use an InBody Tissue to clean the device.
- Do not pour liquid cleaner directly onto the device. If liquid cleaner flows into the device, it may cause an equipment failure or an electric shock due to a short circuit.
- Do not use this device for any purpose other than body composition analysis or weight measurement.
- This product is not a diagnostic device. To make an accurate diagnosis, consult your doctor.

Avertissement

- *Il n'est pas recommandé aux personnes qui portent des dispositifs essentiels à la vie, comme des stimulateurs cardiaques ou des dispositifs de surveillance, d'utiliser cet équipement. De faibles courants électriques circulent dans le corps humain pendant l'analyse, ce qui peut causer une défaillance du dispositif médical et mettre la vie en danger.*
- *Étant donné que la méthode d'analyse par impédance bioélectrique (Bioelectrical Impedance Analysis / BIA) utilise des courants de très faible intensité, elle ne nuit pas au corps. Cependant, les femmes enceintes sont priées de consulter un médecin ou un spécialiste.*
- *Il n'est pas recommandé aux personnes souffrant d'une maladie contagieuse ou infectieuse d'utiliser cet appareil. Si une personne souffrant de toute forme de maladie contagieuse, ou d'infection, utilise l'appareil InBody, utilisez une lingette InBody pour nettoyer l'appareil.*
- *Ne pas verser de détergent liquide sur l'appareil au moment de le nettoyer. Si un liquide devait s'infiltrer dans l'appareil, cela pourrait provoquer une défaillance de l'appareil ou un risque d'électrocution.*
- *N'utilisez pas cet appareil à toute autre fin que l'analyse de la composition corporelle ou la prise de poids.*
- *Ce produit n'est pas un appareil servant à poser un diagnostic. Afin d'obtenir un diagnostic adéquat, veuillez consulter votre médecin.*



Caution

- This is a sensitive device which precisely measures the body composition. If you test near electronic products such as refrigerators, TVs or right under fluorescent lights, the test results may be inaccurate. Please use the device away from electronic devices.
- Do not use the device in a humid space such as a bathroom, as excessively high or low temperature, humidity, and pressure may affect the operation of the device. Use in the installation environment specified in the product specifications.
- Do not allow any liquid substances to contact the device directly. Keep food and drinks away from the device. Substances getting inside the device can cause critical damage to the electronic components.
- Do not disassemble or modify the device including internal parts without written consent from the manufacturer. This may cause electric shock or injury, device malfunction, inaccurate test results, and will void the manufacturer's warranty.
- Children or people with restricted mobility should be tested with the help of an instructor or assistant.
- When storing the device for a long period of time, store it on a flat surface after turning off the device, unplugging the adapter, and packing the device.
- Dispose of the device and its batteries in accordance with the relevant local laws and regulations.
- Repairs and inspections can only be performed by InBody's technician. For repairs and inspections, contact the customer service.
- Do not support yourself on the equipment when stepping up or down from the footplate.
- Please be careful not to trip or get your foot caught in the footplate.
- Failure to follow these instructions may result in product damage or inaccurate test results.
- Failure to comply with safety precautions and regulations may result in the user suffering injuries or incurring property damage.



Attention

- *Si le InBody subit des interférences électriques, les résultats des analyses peuvent s'avérer inexacts. Ne pas installer le InBody à proximité d'éclairage fluorescent, de grands équipements à moteur CA, comme des tapis roulants, plaques de vibration, réfrigérateurs, climatiseurs, compresseurs, dispositifs de traitement par la chaleur à haute fréquence et des appareils de chauffage qui causent des interférences. Lorsque le InBody et un dispositif qui cause des interférences sont branchés dans la même prise, changez l'un ou l'autre de prise.*
- *N'utilisez pas cet appareil dans un endroit humide, comme une salle de bain, puisqu'une température trop élevée ou trop basse, l'humidité, et la pression peuvent affecter son fonctionnement. Utilisez dans un environnement spécifié dans les caractéristiques de produit.*
- *Faites attention à ne permettre à aucun objet étranger (nourriture, breuvage, nettoyants liquides, etc.) de pénétrer l'équipement. Tout objet étranger qui pénètre l'équipement peut causer de sérieux dommages aux composants électroniques.*
- *Ne démontez pas l'équipement de façon aléatoire. Ceci peut causer une décharge électrique, une blessure, un dysfonctionnement du produit des résultats erronés, et l'équipement ne sera pas couvert par la garantie du fabricant.*
- *L'analyse de tout enfant ou toute personne à mobilité réduite doit se faire avec l'aide d'un gérant ou adjoint.*
- *Disposez de l'appareil et de ses piles conformément aux lois et règlements en vigueur dans votre région.*
- *Les réparations et inspections ne peuvent être effectuées que par un technicien InBody. Veuillez contacter le service à la clientèle à cette fin.*
- *Ne vous appuyez pas sur l'équipement lorsque vous montez ou descendez de la plateforme.*
- *Attention à ne pas trébucher ou à vous coincer un pied sur le côté de la plateforme.*
- *Le non-respect de ces directives pourrait endommager le produit ou entraîner des résultats d'analyse inexacts.*
- *Le non-respect des précautions et des règles de sécurité pourrait causer des blessures à l'utilisateur ou provoquer des dommages matériels.*

2 Device Overview

2.1 Unpacking

Open the device packing box and remove the packaging pad. Take the device out of the packing box.

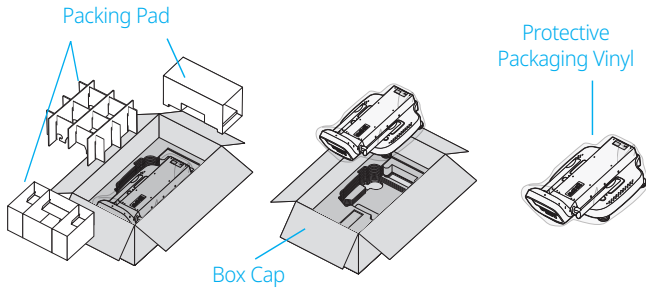

Caution

- When transporting the device, do not grab the upper section or hand electrode connection area.
- For repackaging the device at a later time, the supplied packing materials must be kept. Other wastes should be disposed according to relevant local laws and regulations.
- Be careful not to get your hands or feet caught by the packing box.
- Keep children away from the packing box.
- Do not put protective packaging vinyl on your face.
- Refer to the description below when transporting InBody.



Attention

- Lors du transport de l'appareil, ne pas saisir la partie supérieure ou la zone de connexion des électrodes des mains (les bras).
- Pour le reconditionnement ultérieur de l'appareil, les matériaux d'emballage fournis doivent être conservés. Les autres déchets doivent être éliminés conformément aux lois et réglementations locales en vigueur.
- Veillez à ne pas vous coincer les mains ou les pieds dans la boîte d'emballage.
- Tenez les enfants éloignés de la boîte d'emballage.
- Ne mettez pas le vinyle de protection de l'emballage sur votre visage.
- Reportez-vous à la description ci-dessous lors du transport d'InBody.

2.2 Device Components

Device consists of the following components. Make sure all of the following components are present.

* Please check if the device has any damage prior to installation.

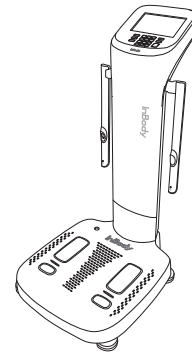

InBody9705

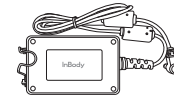

Power Adapter



Power Cable

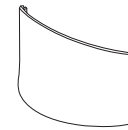

Hinge Cover



User's Manual

2.3 Name of Each Part

Functions

The names and functions of each part of the device are as follows.

* Please check each component for damage prior to installation.

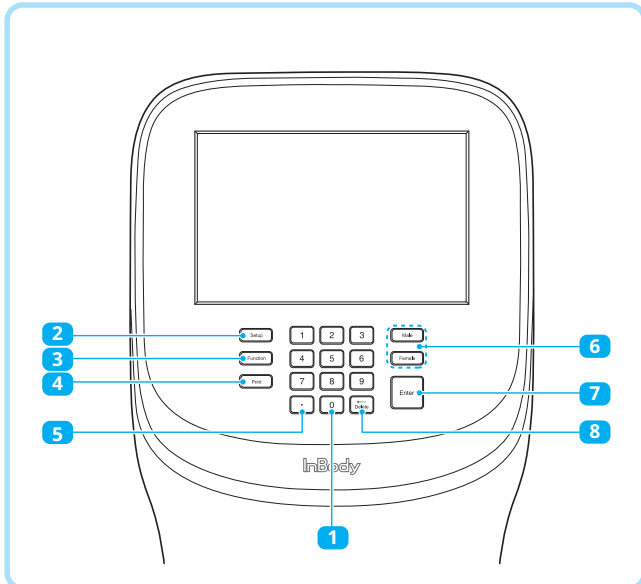

- 1** Number Button: Enter numeric data such as age and height.
- 2** Setup Button: Enter the "Setup" in the Administrator Menu from the test standby screen.
- 3** Function Button: Enter the "FAQ" screen directly from the test standby screen.
- 4** Print Button: Reprint test results.
- 5** Decimal Point Button: Enter the decimal point in ID, height, age and weight.
- 6** M/F: Select between Male or Female.
- 7** Enter Button: Used when input is completed or changes are saved in the Administrator Menu.
- 8** Delete Button: Used to delete the saved data.

Exterior

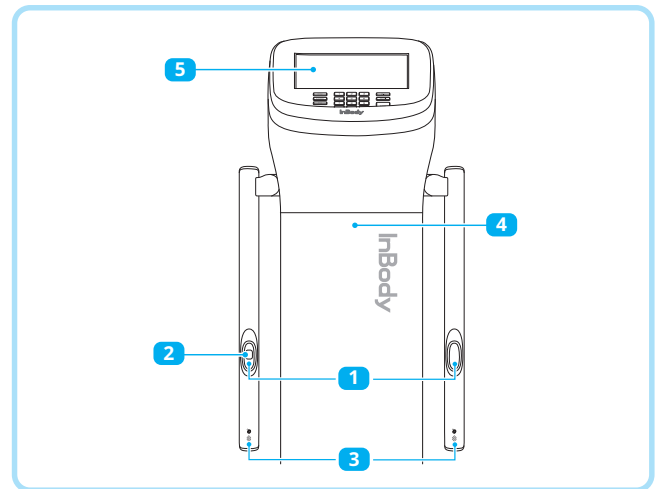

- 1** Hand Electrode: For testing, all four fingers must wrap around the hand electrode to contact the surface, and the thumb touches the thumb electrode.
- 2** Fingerprint Recognition Sensor: The sensor recognizes the fingerprint on the left thumb and saves or loads personal information automatically.
- 3** InBodyBAND Recognition Sensor: Receives personal information in wirelessly connected to InBodyBAND.
- 4** Body: Connects the upper section and the lower section.
- 5** Display: It displays each step of the test, the guide, and the test result. Users can input test data, set the test environment, and view results on the touchscreen.

Footplate

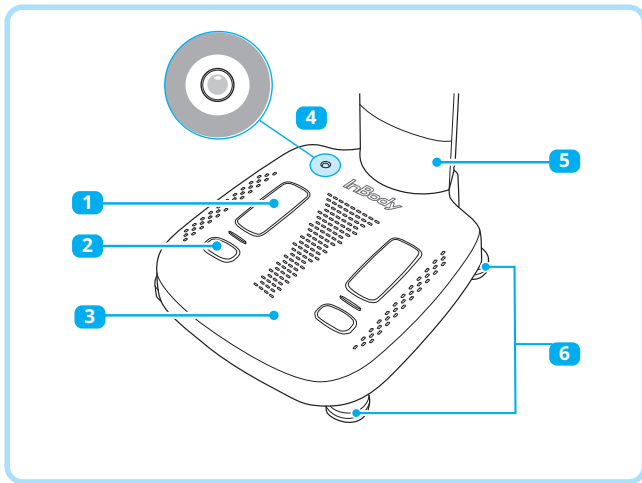

- 1** Front Sole Electrode: This area is the electric contacting area where user's front foot treads to contact during the test.
- 2** Rear Sole Electrode Area: This area is the electric contacting area where user's heel treads to contact during the test.
- 3** Footplate: Connected to loadcells that measure the user's weight.
- 4** Level Indicator: Shows the level status of the device.
- 5** Hinge Cover: Used to cover the connecting part of the upper section and lower section.
- 6** Leveling Supporter: Can fit the level by adjusting the height.

Rear Panel

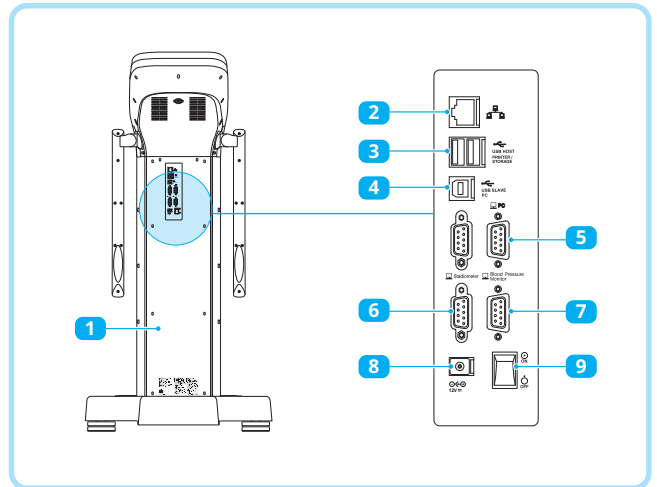

- 1** Rear Cover: Used for inspecting internal inspections, etc. The verified InBody service engineer can only open it.
- 2** LAN Port (10/100 T-Base): Connect the device to the Internet or Lookinbody installed on the PC via a wire connection.
 - * You can connect the InBody to LookinBody installed on the PC if at least one of **2**, **4**, **5** ports is connected.
- 3** USB HOST Port: Connect printer, USB thumb drive and barcode reader.
- 4** USB SLAVE Port: Connect the device to LookinBody installed on the PC.
 - * You can connect the device to LookinBody installed on the PC if at least one of **2**, **4**, **5** ports is connected.
- 5** PC 9-pin Serial Terminal (Female, RS-232C): Can be used to connect the device with LookinBody installed on the PC.
 - * You can connect the device to LookinBody installed on the PC if at least one of **2**, **4**, **5** ports is connected.
- 6** Stadiometer 9-pin Serial Terminal (Female, RS-232C): Connect the InBody with a stadiometer.
 - * Make sure to connect only the InBody stadiometer.
- 7** Blood Pressure Monitor 9-pin Serial Terminal (Female, RS-232C): Connect the device with a blood pressure monitor.
 - * Make sure to connect only the InBody Blood Pressure Monitor.
- 8** Power Jack: Connect a power adapter.
 - * Use the adapter provided by only InBody.
- 9** Power Switch: Turn the device on and off.

3 Installation

3.1 Installation Environment

Check the environment before installing the device. This device is suitable for indoor use. If installing this device outdoors, the following requirements must be fulfilled.

Temperature Range	50 ~ 104 °F (10 ~ 40 °C)
Relative Humidity	30 ~ 75 % RH (No Condensation)
Atmospheric Pressure	70 ~ 106 kPa

3.2 Installation

* Do not transport the device by holding the head.

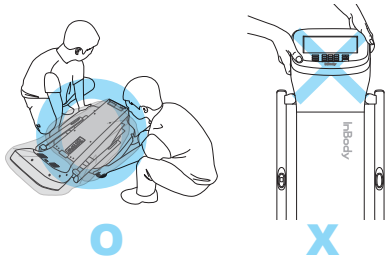

Caution

- Using the device in a dry environment or on a carpet may result in static electricity and damage to the device. Use an antistatic mat if you need to install it in an environment with static electricity.
- Install the device on the flat and vibration-free floor. If the device is installed where the floor is not flat, it may topple during a test or the test results may be inaccurate.
- Do not clean the foot electrode and the hand electrode with detergent. If liquid cleaner flows into the device, it may cause corrosion and malfunction. To clean the device, use the alcohol-based disinfectant (e.g., 70 % ethanol).



Attention

- *L'utilisation de l'appareil dans un environnement sec ou sur un tapis peut provoquer de l'électricité statique et endommager l'appareil. Utilisez un tapis antistatique si vous devez l'installer dans un environnement où l'électricité statique est présente.*
- *Installez l'appareil sur un sol plat et sans vibrations. Si l'appareil est installé sur un sol qui n'est pas plat, il risque de basculer pendant le test ou les résultats du test peuvent être inexacts.*
- *Ne pas nettoyer l'électrode de pied et l'électrode de main avec un détergent. Si un nettoyant liquide s'écoule dans l'appareil, il peut provoquer de la corrosion et un dysfonctionnement. Pour nettoyer l'appareil, utilisez le produit de nettoyage à base d'alcool. désinfectant à base d'alcool (par exemple, de l'éthanol à 70 %).*

- 1 Raise the device upper section to the end and then remove the protective packaging vinyl. Remove the protective packaging material placed over the footplate.

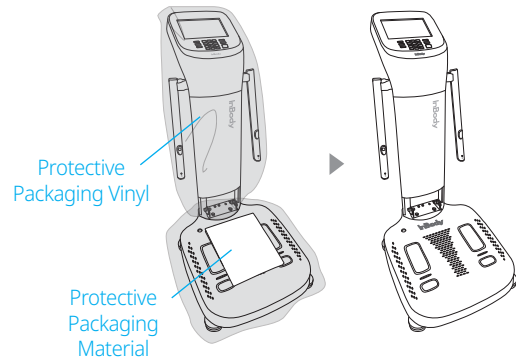

- 2 When assembling the hinge cover, push it slightly in the vertical direction so that the spring ball is inserted in the standing end, and push the hinge cover into the direction of the arrow.

* If the hinge cover is pressed strongly after the spring is inserted fully, or the stand is lowered with it attached, it may cause scratches.

* Be careful not to get your fingers caught when assembling the hinge.

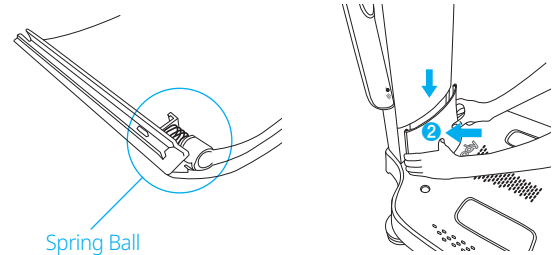

- 3 Adjust the foot supporters to center the bubble in the level indicator and to level the device for accurate weight measurement.

* For accurate weight measurement, the device should be leveled.

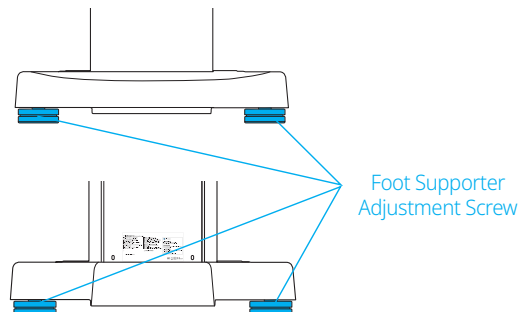

Installation

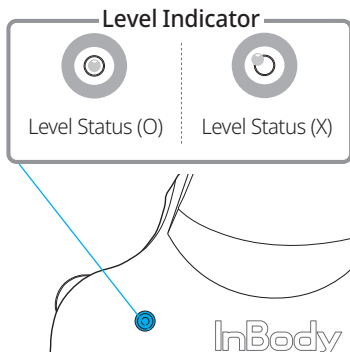

Caution

- Be careful not to get your hands hurt when handling the foot supporter adjustment screw.



Attention

- *Veillez faire attention à ne pas vous blesser les mains lorsque vous manipulez la vis de réglage du support de pied.*

- 4 Connect the power adapter (**2**) to the power inlet on the rear of the device (**1**). Connect the power cable (**3**) to the connected power adapter (**2**). Connect the plug of the power cable (**3**) to a 3-terminal outlet with a ground terminal.

* The device can be connected to optional device such as a stadiometer, and LookinBody. For details to connect, please refer to "5 Connecting Compatible Device" in this User's Manual.

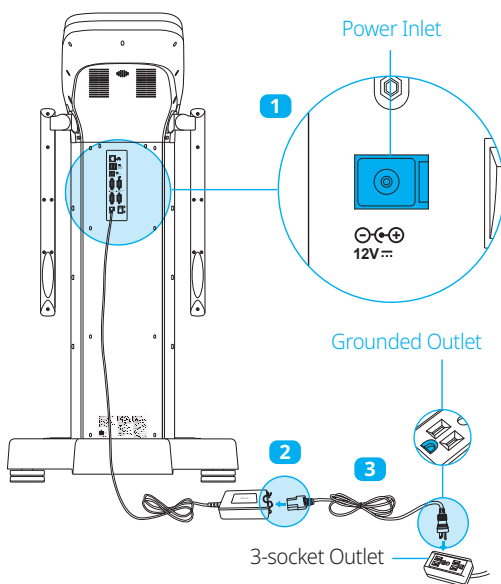

Warning

- Do not pull the power cord violently.
- Do not plug in or pull out the power cord with wet hands. There is a risk of an electric shock.
- Always use an outlet connected to the rated power (AC 100 - 240 V). Using other power-rated outlets may result in fire or malfunction.
- When using a power surge protector, make sure that the outlet or the extension cable has adequate power capacity.
- Do not disassemble or modify the device including internal parts without written consent from the manufacturer. This may cause electric shock or injury, device malfunction, inaccurate results, and will void the manufacturer's warranty.
- Avoid direct contact between the device and other electronic devices while it is on.
- If you have not been using the device for a long time, unplug the power cord.



Attention

- *Ne pas tirer violemment sur le cordon d'alimentation.*
- *Ne pas brancher ou débrancher le cordon d'alimentation avec des mains mouillées. Il y a risque d'électrocution.*
- *Utilisez toujours une prise de courant connectée à la puissance nominale (AC 100 - 240 V). L'utilisation d'une prise de courant d'une autre puissance peut entraîner un incendie ou un dysfonctionnement.*
- *Lors de l'utilisation d'un parasurtenseur, assurez-vous que la prise ou le câble de rallonge a une capacité électrique suffisante. ou le câble d'extension a une capacité de puissance adéquate.*
- *Ne pas démonter ou modifier l'appareil, y compris les pièces internes, sans l'accord écrit du fabricant. Cela pourrait provoquer des chocs électriques ou des blessures, un dysfonctionnement de l'appareil, des résultats imprécis et annulera la garantie du fabricant.*
- *Évitez tout contact direct entre l'appareil et d'autres appareils électroniques lorsqu'il est allumé.*
- *Si vous n'avez pas utilisé l'appareil pendant une longue période, débranchez-le. le code d'alimentation.*

Caution

- The device may get damaged or malfunctioned due to the electric if plugging into an ungrounded outlet. Or the test results may be inaccurate.
- If the device is subjected to electrical interference, the test results may be inaccurate. Do not install the device in close proximity with fluorescent lights, the device with a large AC motors such as treadmills, vibrating platform refrigerators, air conditioners, compressors, etc., high-frequency heat treatment devices, and heating devices that cause electrical interference. Unplug and plug them into different power outlets when the device and a device that causes electrical interference are connected to the same power outlet.
- If you are connecting the device to another device then turn on the other device first. On the contrary, turn off the power of the device first, and then turn off the power of the other device when turning off the power. This can minimize the electric shock to the device.
- Use the adapter provided by the device. The device may malfunction when other adapters are used.
- If you are operating the device at a place where the altitude is 2,000 m (6562 ft.) or higher, the weight measurement may be affected.
- Do not use the device near heat sources such as heating appliances. It may cause deformation, breakdown or fire by heat.
- Use the device in a location where it is not exposed to direct sunlight. It may cause discoloration or damage to the device.
- Be careful not to pull the cables connected to the device. Otherwise, it may cause a weight measurement error.

Attention

- *L'appareil risque d'être endommagé ou de mal fonctionner à cause de l'électricité. électrique s'il est branché sur une prise non reliée à la terre. Ou Les résultats des tests peuvent être imprécis.*
- *Si l'appareil est soumis à des interférences électriques, les résultats du test peuvent être inexacts. N'installez pas l'appareil à proximité de lampes fluorescentes, d'appareils dotés d'un grand moteur AC comme les tapis roulants, les plates-formes vibrantes, les réfrigérateurs, les climatiseurs, les compresseurs, etc. les appareils de traitement thermique à haute fréquence et les appareils de chauffage qui provoquent des interférences électriques. Débranchez-les et branchez-les sur des prises de courant différentes lorsque l'appareil et un appareil provoquant des interférences électriques sont branchés sur la même prise de courant.*
- *Si vous connectez l'appareil à un autre appareil, allumez d'abord l'autre appareil. Au contraire, éteignez d'abord l'appareil, puis éteignez l'autre appareil lors de la mise hors tension. Cela permet de réduire les risques de choc électrique de l'appareil.*
- *Utilisez l'adaptateur fourni par l'appareil. L'appareil peut mal fonctionner si d'autres adaptateurs sont utilisés.*
- *Si vous utilisez l'appareil dans un endroit où l'altitude est de 2 000 m (6562 ft.) ou plus, la mesure du poids peut être affectée.*
- *N'utilisez pas l'appareil à proximité de sources de chaleur telles que des appareils de chauffage.*
- *Utilisez l'appareil dans un endroit où il n'est pas exposé à la lumière directe du soleil. Cela peut entraîner une décoloration ou une détérioration de l'appareil.*
- *Veillez à ne pas tirer sur les câbles connectés à l'appareil. Dans le cas contraire, une erreur de mesure du poids pourrait se produire.*

- 5 Press the power switch to turn it on.

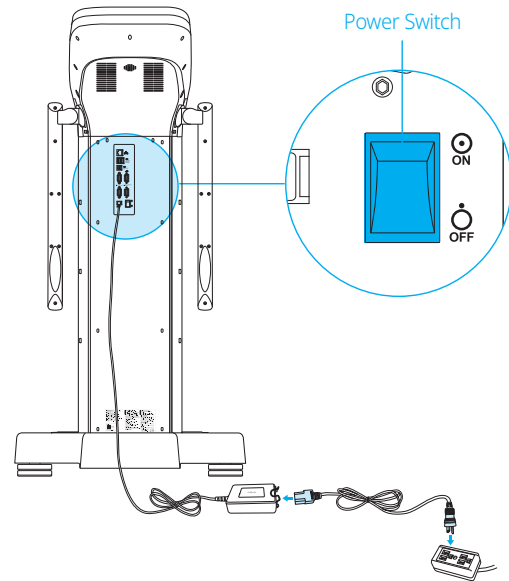

4 Setting

4.1 Initial Setup

1 The device automatically starts booting when it is turned on. While booting, it performs a self-weight calibration.

- * While booting about 5 minutes, make sure there is nothing on top of the footplate. Please do not stand on the footplate, or place objects on the footplate.

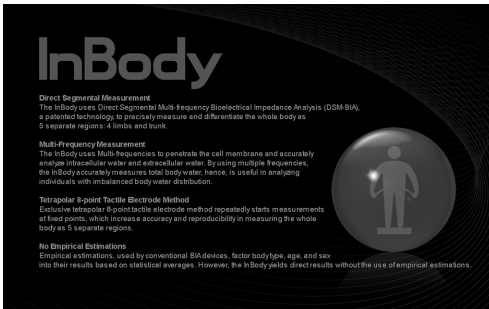

2 Press the [Administrator Menu] on the test standby screen.

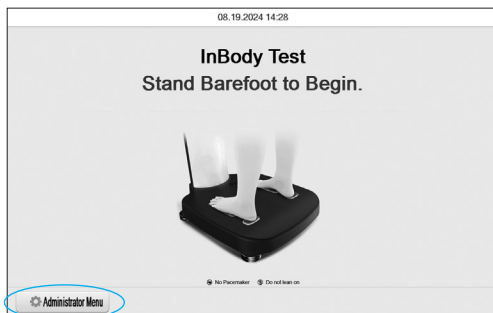

Administrator Menu Button

3 Enter the administrator password to set the password. This screen will appear only once for the initial password setup.

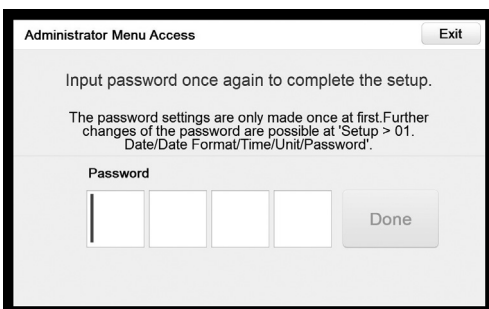
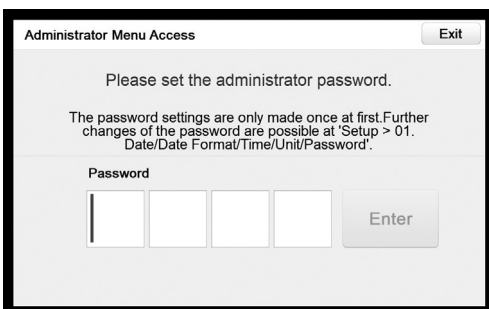

- * Be careful not to forget the password you set. If you have forgotten your password, please contact InBody Customer Service

4 You will see "Setup" and "FAQ" when you enter the Administrator Menu.

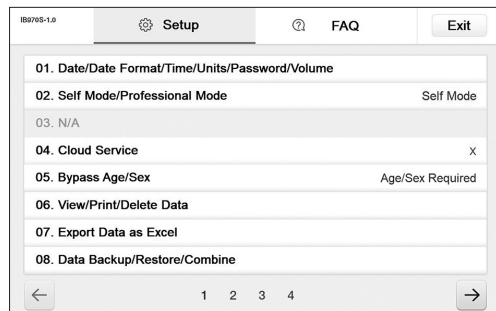

Setup

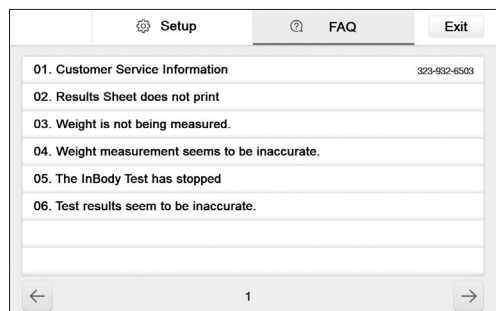

FAQ

Setup

Configure settings and manage data according to the test environment.

- 01 Date/Date Format/Time/Units/Password/Volume**
: This option allows you to change the basic settings of the device.
- 02 Self Mode/Professional Mode**
 - Self Mode: The subject takes the InBody Test by entering only his/her height. Throughout the test, instructions and the InBody Information will be shown on the screen.
 - Professional Mode: An instructor is present and guides the subject throughout the InBody Test.
- 03 N/A**
- 04 Cloud Service**
: InBody App provides services that allow members to check and manage results themselves. If you enter your mobile phone number, you can check the results on the member's mobile phone as the InBody results are transmitted to InBody Cloud.

05 Bypass Age/Sex

: The subject can bypass inputting their age or sex if the test environment is designed for testing a specific age group or sex.
* 'M/F' refers to biological sex of the user, male or female.

06 View/Print/Delete Data

: This option allows checking, printing or deleting the test result stored in the device as a membership number or mobile number.

07 Export Data as Excel

: This option allows for the copying of the test result saved in the device to InBody USB in Excel file format.

08 Data Backup/Restore/Combine

: This option allows saving the test results to InBody USB for backup or restores the test results backed up to the device. If you are using multiple devices, the data can be merged together.

09 Printer Setup

: This option allows the printer to connect to the device. Connect the printer to the device to print your Result Sheet.

10 Result Sheet Types

: This option allows you to set and select which Result Sheet to print. (InBody Result Sheet, Body Water Result Sheet)

11 Automatic Printing Options

: This option allows setting the Result Sheet to be printed automatically after completing the test. You can print up to two Result Sheets per type of Result Sheet at one time.

12 N/A**13 Outputs/Interpretations for Result Sheet**

: This option allows setting the parameters or explanations that appear on the right side of the InBody Result Sheet, InBody Result Sheet for Children, and Body Water Result Sheet

14 Result Sheet Custom Logo

: You can preview the logo printed on the upper right of the Result Sheet.
* Please contact Customer Service for help with uploading or modifying a logo.

15 Printing Alignment

: This option allows for the adjustment of the result to be printed on the Result Sheet.

16 Internet Options

: Connect the device to the Internet via Wi-Fi or LAN. Once the device is connected to the Internet, the InBody Test results can be sent to the cloud, or the LookinBody that can be connected remotely.

17 Bluetooth

: This option allows setting up the Bluetooth so that the device can connect to LookinBody, or to other compatible devices such as BSM Stadiometer series, or BPBIO Blood Pressure Monitor series.
* For details on connecting Bluetooth, please refer to "5 Connecting Compatible Device" in this User's Manual.

18 Manual/Automatic Weight

: Select whether to proceed with testing by entering the subject's weight manually or by taking the weight measurement automatically.

19 Adjust Weight

: Adjust measured weight by a fixed value on the device. (Example: Workout clothes at the gym are approximately 0.4 lb (0.2 kg); most people are assumed to be wearing workout clothes, so the instructor may adjust the set value to -0.4 lb (-0.2 kg).)

20 Reference Range

: This option allows setting the normal range of BMI and Percent Body Fat.
* The ideal value of BMI may also be set.

21 N/A**22 N/A****23 Touchscreen Alignment**

: This option allows for the accuracy of the touch screen to be calibrated.

24 Customer Service Information

: Save the Customer Service contact information. Please refer to the Customer Service information if you have any inquiries regarding the InBody Test, or problems that cannot be resolved through the 'FAQ' menu.

25 Auto-Lock

: This option allows setting the time before the screen is locked and the corresponding password to restrict using the device.

26 Etc. Function Setup

: You can select between fingerprint or InBodyBAND recognition and choose to print the Total Body Composition History.

FAQ

Refer to additional information on how to use the InBody.
Refer to FAQ checklist when there are problems that occur while using the device.

01 Customer Service Information

: Refer to the customer service contact information in "Setup: 24. Customer Service Information."
Please contact the customer service if your problem cannot be resolved through the FAQ or if you need further inquiries regarding the InBody Test.

02 Result sheet does not print.

: View the FAQ checklist when the Result Sheet does not print.

03 Weight is not being measured.

: View the FAQ checklist when weight is not being measured.

04 Weight measurement seems to be inaccurate.

: View the FAQ checklist when the weight measurement seems to be inaccurate.

05 The InBody Test has stopped.

: View the FAQ checklist when the InBody Test has stopped.

06 Test results seem to be inaccurate.

: View the FAQ checklist when the test results seem to be inaccurate.

5 Connecting Compatible Device

To connect a compatible device to the device, check the communication method of the compatible device.

There are two ways of communication; wired connection such as USB or RS232C (9-pin serial terminal, Female), and wireless connection (Bluetooth).

5.1 Printer

The Result Sheet can be printed if the printer is connected to the device.

- 1 Turn off the device.
 - * When the device is already turned on, the printer might not properly connect.
- 2 Connect the USB cable supplied with the printer to the USB HOST printer terminal on the rear of the device. Connect the other end of the USB cable to the printer's USB connection terminal.
- 3 You can set the options related to printing from "10. Result Sheet Types" to "15. Printing Alignment" in Setup in the Administrator.

5.2 Stadiometer

The height values measured by the stadiometer are sent to the device when it is connected to the device.

* Make sure to connect only BSM Stadiometer series provided by InBody.

- 1 Turn off the device.
 - * When the device is already turned on, the stadiometer might not properly connect.
- 2 Connect the serial cable supplied with the stadiometer to the stadiometer 9-pin the serial terminal on the rear of the device. Connect the other end of the cable to the serial terminal of the stadiometer.
- 3 Turn on the stadiometer.
- 4 Turn on the device. When the stadiometer is connected, () icon will be displayed in the upper left of the test standby screen.

5.3 Blood Pressure Monitor

The blood pressure values measured by the blood pressure monitor are sent to the device when it is connected to the device.

- * Make sure to connect only the BPBIO Blood Pressure Monitor series provided by InBody.
- * If you select the type of Result Sheet at "13. Outputs/ Interpretations for Result Sheet" in Setup in the Administrator Menu and then select blood pressure in the sub-options, then you can print the blood pressure value on the InBody Result Sheet.

- 1 Turn off the device.
 - * When the device is already turned on, the blood pressure monitor might not properly connect.
- 2 Connect the serial cable supplied with the blood pressure monitor to the Blood Pressure Monitor 9-pin serial terminal on the rear of the device. Connect the other end of the cable to the serial terminal of the blood pressure monitor.
- 3 Turn on the blood pressure monitor.
- 4 Turn on the device. When the blood pressure monitor is connected, () icon will be displayed in the upper left of the test standby screen.

5.4 Barcode Reader

The ID will be inputted automatically if a barcode reader is connected to the device.

* If the barcode reader is not recognized, please contact InBody Customer Service.

- 1 Turn off InBody device.
 - * When the device is already turned on, the barcode reader might not properly connect.
- 2 Connect the USB cable of the barcode reader to the USB HOST port on the rear of the device.
- 3 Turn on the device. When the barcode reader is connected, () icon will be displayed in the upper left of the test standby screen.

Caution

- Be careful not to pull the device when you are connecting the cable to the device for interacting with external devices. Otherwise, it may cause a weight measurement error.
- Avoid laying cables connected to external devices in frequently traveled passages because individuals may trip over cables and become injured.
- Do not connect external devices that are not specified from InBody to the InBody970. Otherwise, it may cause failure and malfunction.

Connecting Compatible Device



Attention

- Faites attention à ne pas tirer l'équipement lors du branchement de dispositifs externes à celui-ci. Ceci peut causer une erreur dans la mesure du poids.
- Évitez de poser des câbles de dispositifs externes dans les endroits passants, et ce, pour éviter que des personnes trébuchent et se blessent.
- Ne branchez pas au InBody970 des dispositifs externes non précisés par InBody. Ceci peut causer un échec ou un dysfonctionnement.

5.5 LookinBody

By connecting LookinBody to the device, you can manage your InBody data.

* If LookinBody is not recognized, please contact InBody Customer Service.

- 1 Turn off the device.
 - * When InBody device is already turned on, LookinBody might not properly connect.
- 2 If the PC has a serial port, connect the serial cable provided with LookinBody to the PC 9-pin serial terminal on the rear of the device, and connect the other end of the serial cable to your PC.

If there is no serial port on your PC, you can connect a normal USB-AB type cable to the USB SLAVE port on the rear of InBody device instead, and connect the other end of the USB cable to the USB port of the PC.

- 3 Turn on the device. Then launch LookinBody installed on your PC and follow its instructions to connect to the device.



Caution

- When you are connecting the cable to the device, be careful not to move or pull the device. It may cause a weight measurement error.
- Avoid laying cables connecting to compatible devices where people frequently pass. This may cause individuals to trip over or become injured.
- Do not connect compatible devices that are not specified provided by InBody to the InBody. Otherwise, it may cause malfunction.

5.6 Connecting Bluetooth

Requirements

- The compatible device to be connected must support Bluetooth.
- Bluetooth may not operate normally if the compatible device is more than 10m away from the InBody device.
- There should be no obstacles such as walls between the InBody device and the compatible device.

Connecting Stadiometer/Blood Pressure Monitor/InGrip

- 1 Press the [Administrator Menu] on the test standby screen.
- 2 Enter the password to enter the Administrator Menu.
- 3 Go to the "17. Bluetooth" in Setup.
- 4 If "O" is selected on "Connect via Bluetooth?", you can select "LookinBody" or "Compatible device". Then, please select the "Compatible device" for device connection.
 - * If LookinBody and the device are connected via Bluetooth, selecting a compatible device will disconnect them.

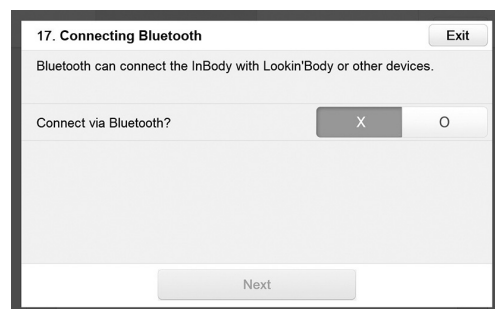

- 5 Turn on one of the InBody recommended compatible device and check the device name and serial number on the nameplate attached to the compatible device.

- 6 Choose the compatible device to be connected and then press [Next].

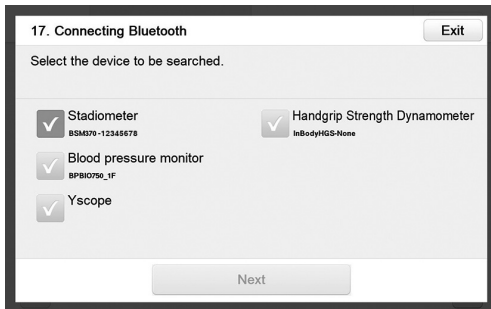

- 7 The compatible device's Bluetooth ID consists of "Device Name-Serial Number", and select the Bluetooth ID of the device to be paired and press [Connect].

* If the Bluetooth ID does not appear or the connection is not good, please contact InBody Customer Service.

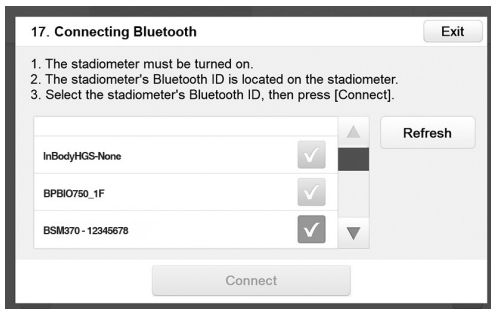

- 8 If the compatible device is paired properly, the Bluetooth ID of the device connected to the device will appear as shown below.

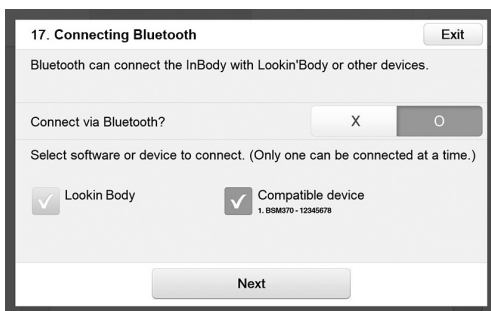

- 9 Press [Exit] to return to the test standby screen, and the Bluetooth icon and the corresponding device icon will be displayed on the upper left corner screen.

* The screen below shows that the device was connected with stadiometer, blood pressure monitor, and barcode reader (USB).

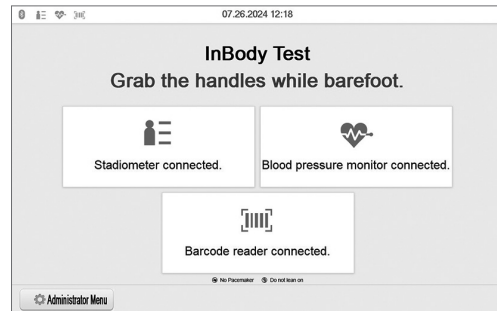

5.7 Connecting Internet

Once the device is connected to the Internet, you can use it to connect to the Cloud Services or LookinBody Web.

* If the Cloud Service does not work or if LookinBody Web is not recognized, please contact InBody Customer Service.

Connecting LAN

- 1 Press the [Administrator Menu] on the test standby screen.
 - 2 Enter the password to enter the Administrator Menu.
 - 3 Go to "16. Internet Options" in Setup.
 - 4 Press LAN and then press [Next].
- * You may need to enter the IP address or DNS address manually depending on the service area. In this case, press the corresponding Bluetooth icon button to use.

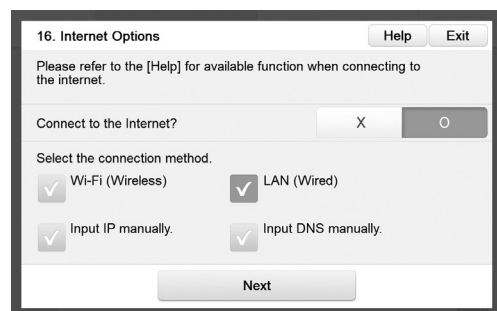

Connecting Compatible Device

5 Connect the LAN cable to () shape port on the rear of the device.

* LAN cable should be connected to a device terminal with internet service or to a connector on the wall.

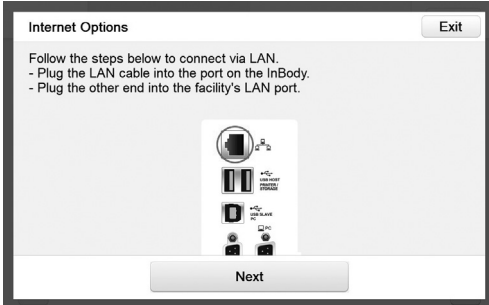

6 You can connect to LookinBody Web or use the Cloud Service through LAN after completing an internet connection.

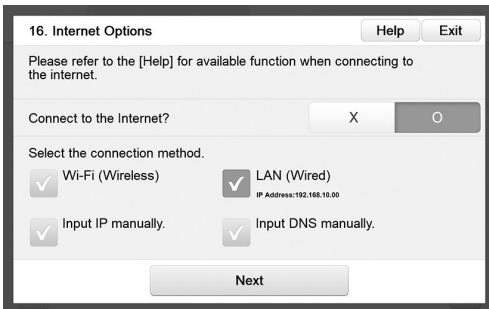

Connecting Wi-Fi

1 Press the [Administrator Menu] on the test standby screen.

2 Enter the password to enter the Administrator Menu.

3 Go to "16. Internet Options" in Setup.

4 Press Wi-Fi and press [Next].

* Depending on the service area, you may need to enter the IP address or DNS address manually.

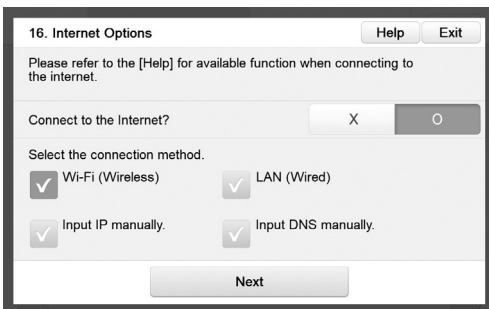

5 Select the Wi-Fi network to connect to.

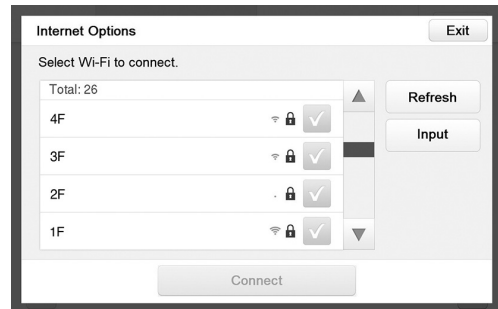

6 Enter the Wi-Fi password if needed.

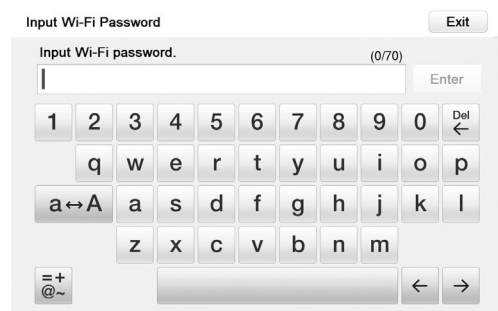

7 You can connect to LookinBody Web or use the Cloud Service through Wi-Fi after completing internet connection.

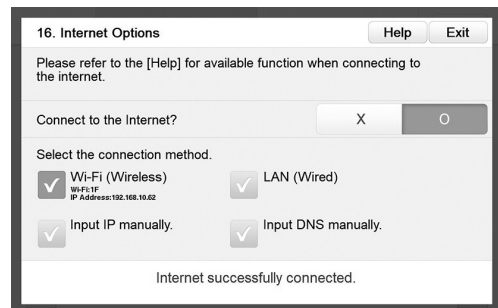

6 InBody Test

6.1 Precautions for Test

Warning

- Individuals with medical implant devices such as pacemakers, or essential support devices such as patient monitoring systems, must not use this equipment. Safe, low-level currents will flow through the body during the test, which may cause malfunctioning of an implanted device, which could potentially endanger the life of the examinee.
- Children and people with limited mobility should be supervised or assisted when attempting to test on the InBody.
- After an individual with any kind of contagious disease or infection tests on the InBody, use an InBody Tissue to clean the equipment.

Avertissement

- *Toute personne qui a un implant médical tel un stimulateur cardiaque ou un dispositif d'assistance essentiel comme appareil médical de surveillance ne doit pas utiliser cet équipement. Des courants sécurisés et à de faibles niveaux traverseront le corps pendant le test et cela peut provoquer un mauvais fonctionnement de l'appareil ou mettre des vies en danger.*
- *Les enfants et les personnes à mobilité réduite doivent être supervisés ou assistés, lorsqu'ils essaient de faire le test sur l'InBody.*
- *Après qu'un individu affligé d'une maladie contagieuse ou d'une infection ait effectué le test sur l'InBody, utilisez un InBody Tissue pour nettoyer les équipements.*

Caution

- Stand upright for about 5 minutes before testing. Taking the test immediately after lying in bed or sitting for a long period of time might result in a slight change in the test results. This is because body water tends to move to the lower body as soon as the person stands or gets up.
- Do not eat before testing. In cases where the examinee has already eaten, the test should be put off for at least two hours after the meal. This is because food mass is included in the examinee's weight and may result in measurement errors.
- Use the bathroom before testing. Waste is not included in the body's compositional elements, but the volume of urine and excrement is included in the weight measurement which may affect the accuracy of the test results.
- Do not exercise before testing. Strenuous exercise or sharp movements can cause temporary changes in body composition. Even light exercise can change your body composition temporarily.
- Take the test in the morning, if possible. Body water tends to gravitate towards the lower body throughout the day, affecting accuracy of the test results.
- Thoroughly wipe the palms and soles with the InBody Tissue before testing. Testing may be difficult if the examinee's palms and soles are too dry or if the examinee has too many calluses.
- Avoid contact with the examinee during testing. Contact may lead to interference, which may affect test results.

Attention

- *Tenez-vous debout pendant environ 5 minutes avant le test. Effectuer le test immédiatement après avoir été allongé dans un lit ou avoir été assis pendant une longue période peut causer un léger changement dans les résultats du test car les liquides corporels ont tendance à se déplacer vers la partie inférieure du corps lorsque la personne est debout ou se lève.*
- *Ne pas manger avant le test. Dans les cas où le candidat a déjà mangé, le test doit être reporté à au moins deux heures après le repas. Cela est nécessaire car la masse alimentaire est incluse dans le poids du candidat et ainsi, peut entraîner des erreurs de mesure.*
- *Allez aux toilettes avant d'effectuer le test. Les déchets organiques ne sont pas inclus dans les éléments de composition du corps, mais le volume d'urine et d'excréments est inclus dans la mesure du poids. Cela affecte la précision des résultats du test.*
- *Ne faites pas de sport avant le test. Des exercices intensifs ou des mouvements brusques peuvent provoquer des changements temporaires de la composition corporelle. Même de légers exercices peuvent temporairement changer votre composition corporelle.*
- *Faites le test le matin, si cela est possible. Les liquides corporels tendent à graviter vers la partie inférieure du corps tout au long de la journée, affectant la précision des résultats.*
- *Avant le test, bien essuyer la paume des mains et la plante des pieds avec l'InBody Tissue. Effectuer le test peut être difficile si les paumes et les plantes du candidat sont trop sèches ou si le candidat a trop de callosités.*
- *Évitez tout contact avec le candidat lors du test. Ce contact peut entraîner des interférences qui pourraient modifier les résultats du test.*

6.2 Test Instructions

The screen changes during the test depending on the setting in "02. Self Mode/Professional Mode" in the Administrator Menu.

- Professional Mode: The screen is configured for testing with an instructor. (Measurement information is managed by user ID).
- Self Mode: The screen is configured for testing alone. (Measurement information is managed by phone number).

- 1 Step up onto the footplate with barefoot.



2 The device starts weight measurement.

- * Make sure that the subject stands alone on the device. It may affect the weight measurement when other people lean or touch the device.

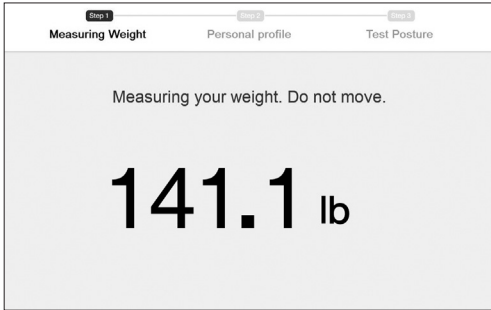

3 Connecting InBodyBAND.

- * If InBodyBAND is connected with iOS, turn off the Bluetooth setting and use it.
- * The InBodyBAND firmware version must be "V038N" or later and include "N" at the end of the version name in order to support the interconnection function. (To check the version of InBodyBAND, select "More" and then select "Preferences" - "Device Settings" in the mobile app.)
- * Self Mode: The screen is configured for testing alone. (Measurement information is managed by phone number).
- * Starting provided by InBodyBAND, a recognition function is provided.



4 Personal information is received from the InBodyBAND and displayed on the screen automatically. The last three digits of the mobile number are censored with an asterisk(*).

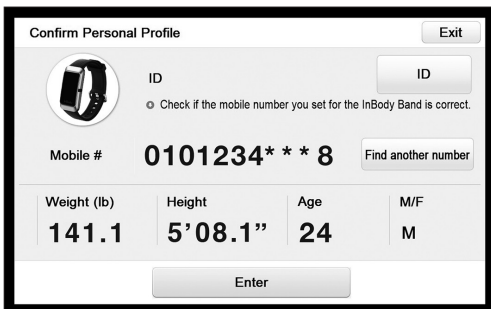

5 When pressing [Exit] or if InBodyBAND is not recognized, the device checks your fingerprint.

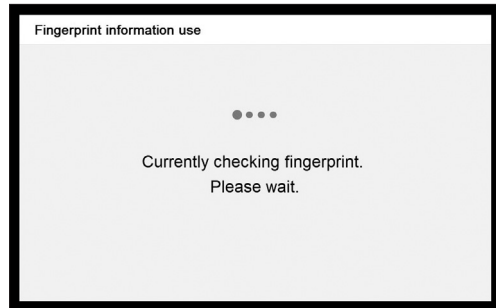

6 If your fingerprint is recognized, the personal information will be automatically displayed on the screen, as shown below.

- * If fingerprint is placed differently from when it was initially registered, personal information may not load properly. For details, please refer to "8.1. Regarding the Device" in "8. Frequently Asked Questions (FAQ)".

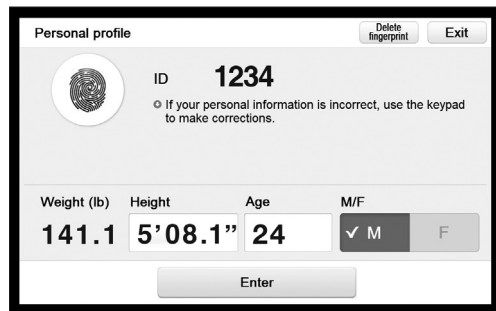

7 If you press [Exit] on the fingerprint identification screen, you may enter your customer information (ID or mobile number).

- * For Professional Mode, enter your ID.
- * For Self Mode, enter your mobile number.

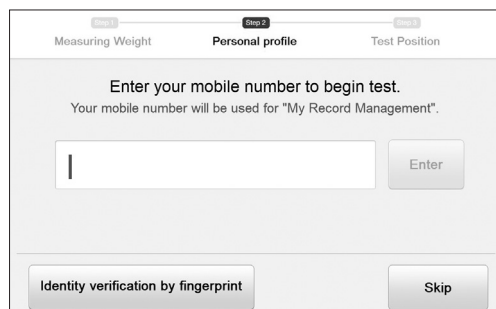
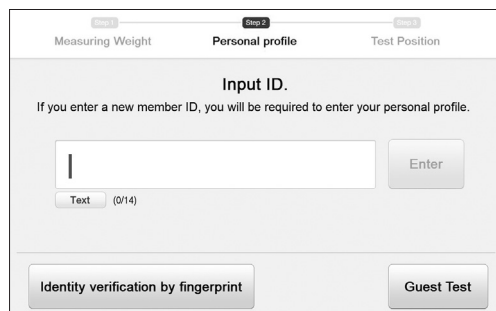

8 If you do not want to enter your ID or mobile number, you can press [Guest Test] or [Skip] and enter only your height, age, and sex to perform the test.

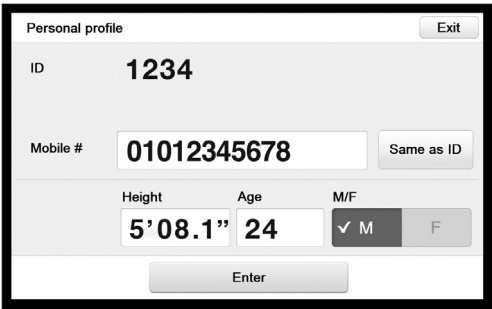

9 Maintain proper posture to take the test.
 * For proper test posture, refer to "6.3. Test Posture".
 * When the hand and foot electrode is recognized, the InBody Test begins automatically.

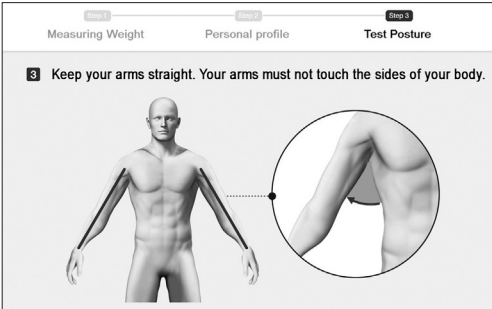

10 InBody Test begins.
 * It will take 90 seconds to complete the test.

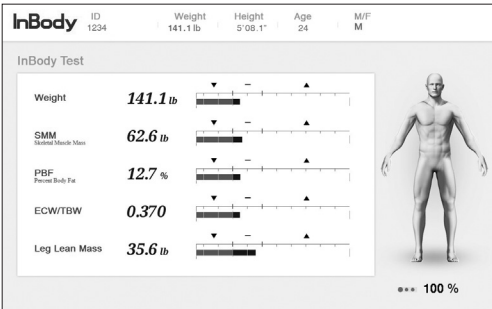

11 The result screen is displayed after completing the test. If a printer is connected to the device, you can check the result according to the selected type of Result Sheet.
 * Please refer to the "4. Setting" in the Administrator Menu for details of printer and Result Sheet setting.



12 Press [Exit] to end the measurement.



6.3 Test Posture

The subject must maintain proper posture to have accurate test results.

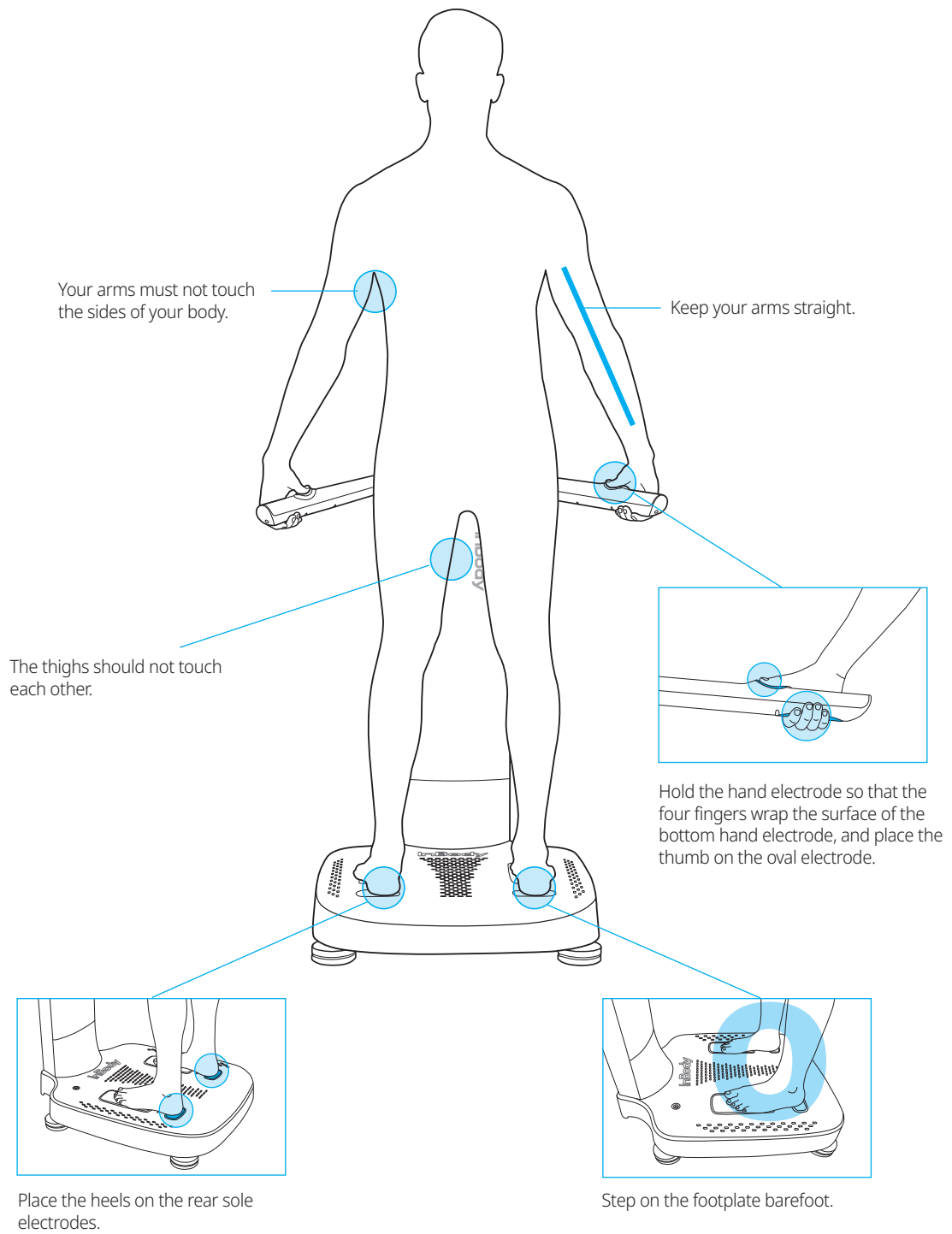

7 Maintenance and Storage

7.1 Precautions for Maintenance



Caution

- Do not bend the handles of the hand electrodes or rotate them in the reverse direction beyond their limitation.
- Do not extend the handles of the hand electrodes beyond their limitation.
- Do not place any objects on the footplate.
- Do not apply excessive force on the equipment.
- Turn off the equipment if you are not using it for a day or longer.
- Do not allow any liquid substances to contact the equipment directly. Keep food and drinks away from the equipment. Substances getting inside the equipment can cause critical damage to the electronic components.
- Use a lint-free cloth to gently wipe the external surface of the equipment about once every week. Be careful not to scratch the LCD screen.
- Device does not need regular maintenance. If some problems occur while operating the device, get in touch with the store where you purchased it or A/S manager. We do not take the responsibility about problems caused by any arbitrary repairs.



Attention

- *Veillez à ne pas tordre les poignées des électrodes à main ou à ne pas les faire pivoter dans le sens inverse, au-delà de ses limites.*
- *Ne prolongez pas les poignées des électrodes à main au-delà de ses limites.*
- *Ne placez pas d'objets sur le repose-pieds.*
- *N'exercez pas de force excessive sur l'équipement.*
- *Éteignez l'équipement si vous ne l'utilisez pas pendant un jour ou plus.*
- *Ne laissez pas de substances liquides rentrer en contact direct avec les équipements. Éloignez les aliments et les boissons de l'équipement. Les substances qui pénètrent à l'intérieur de l'équipement peuvent entraîner des dommages sur les composants électroniques.*
- *Utilisez un chiffon non pelucheux pour nettoyer légèrement la surface externe de l'équipement, environ une fois par semaine. Veillez à ne pas rayer l'écran à cristaux liquides.*
- *Device ne nécessite pas d'entretien régulier. Si des problèmes surviennent pendant le fonctionnement de l'appareil, rentrez en contact avec le magasin où vous l'avez acheté, ou le gestionnaire A/S. Nous ne sommes pas responsables des problèmes occasionnés par des réparations arbitraires.*

7.2 Cleaning

Use the alcohol-based disinfectant (e.g., 70 % ethanol) for 1 minute to clean the surfaces of the device.

7.3 Disinfecting

- 1 Use the alcohol-based disinfectant (e.g., 70 % ethanol).
- 2 Follow the instructions on the disinfectant.
- 3 Disinfect the device: Comply with the intervals specified in the table below.

Interval	Component
Before every measurement	Hand electrodes and Foot electrodes
After every measurement	Hand electrodes and Foot electrodes

7.4 Repacking and Transportation

Once the device is installed, avoid transporting the device. If it must be transported, repack it in the following sequence.

* To transport the device safely, two people should keep the device in a horizontal position.



Caution

- Always use the protective packing materials provided by InBody when repacking.



Attention

- *Utilisez toujours les matériaux d'emballage protecteurs fournis par InBody lors du remballage.*

1 Turn off the the device.

2 Remove all connected adapters, cables, and the hinge cover. Press both gaps of the hinge cover and press it slightly in the vertical direction and pull it in the arrow direction.

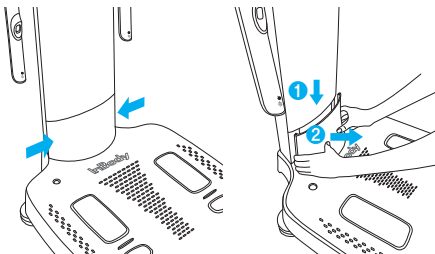

3 Wrap the InBody with protective plastic vinyl. Cover the foot electrodes with protective packaging and fold the top as shown below.

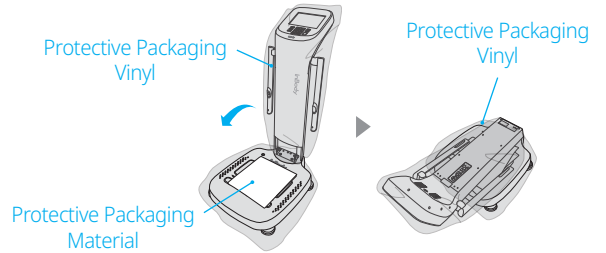

4 Place the device into the box as shown in the sequence below. Put the protective packaging material (paper) as shown in the figure and seal it. After sealing it, transport it only by holding the handle.

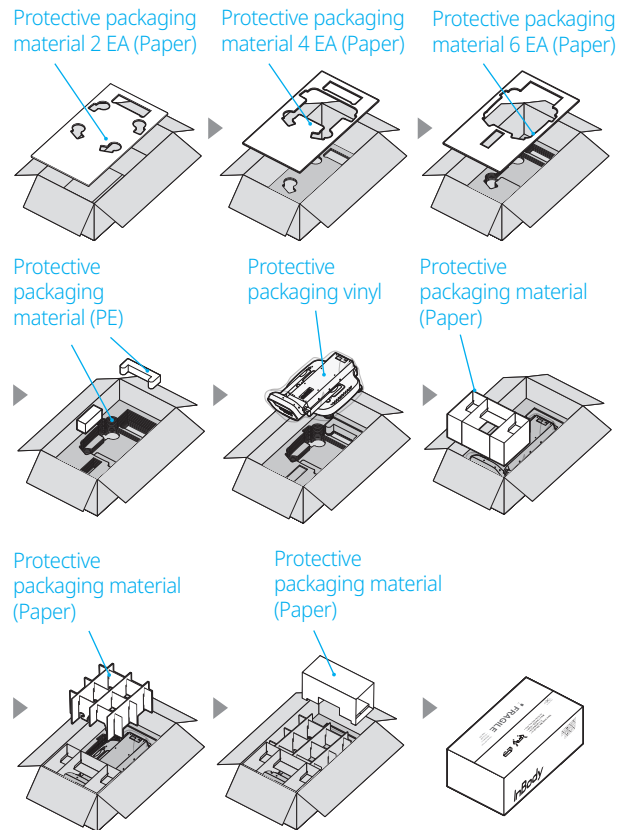

7.5 Storage Environment

The device should be transported or stored under the following conditions.

Temperature Range	-4 ~ 158 °F (-20 ~ 70 °C)
Relative Humidity	10 ~ 80 % RH (No Condensation)
Atmospheric Pressure	50 ~ 106 kPa

8 Frequently Asked Questions (FAQ)

This section includes frequently asked questions and answers for the device. If a problem persists even after checking below, please contact the Customer Service. For contact information, please check "24. Customer Service Information" at "FAQ" in the Administrator Menu of the device.

8.1 Regarding the Device

If a problem arises with the device, you may first attempt to check the "FAQ" in the Administrator Menu. The device can help you diagnose and solve some problems. If your problem cannot be resolved through the "FAQ", please refer to the possible solutions below.

Question: Power does not turn on.

Answer:

- Insert the power plug completely into a grounded 3-socket outlet.

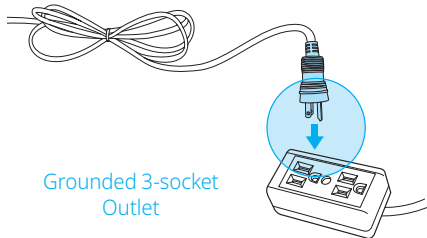

- When using a power strip, the power will not turn on when the power switch of the power strip is turned off. Check the power strip with the power cable connected.

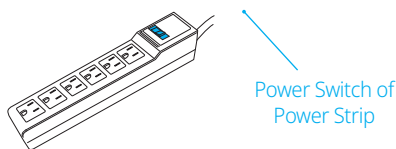

- The problem may occur if the power cord is not completely plugged into the adapter. Insert the power cord completely into the adapter.

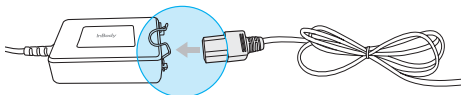

- The problem may occur if you are using the power adapter that is not provided by InBody. Always connect a power adapter (DC 12 V, 5.0 A/3.34 A) provided by InBody.

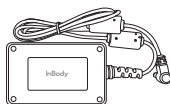

Power Adapter

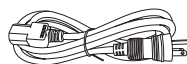

Power Cord

Question: My touchscreen is inaccurate or not responsive.

Answer:

- Calibrate the touchscreen under Settings of the Administrator Menu "23 Touchscreen Alignment".
 - * Press firmly to optimize touchscreen response.
- If you cannot enter the Administrator Menu due to touchscreen problems, please restart the InBody. The InBody stores the last touchscreen alignment and will automatically recall the previous touchscreen settings. The InBody can also recognize if its touchscreen alignment is off screen and will automatically take the user to the calibration screen after restarting.

Question: How to connect with the compatible devices.

Answer:

- Please refer to "5 Connecting Compatible Device" in this User's Manual.

8.2 Regarding the InBody Test

Some of the more common clinical questions are answered below. If additional questions or more clarification is desired, please contact InBody.

Question: Must socks or stockings be removed for the InBody Test?

Answer: Bare skin contact is essential in the BIA method analysis. Socks or stockings may cause a varying degree of distortion in the results. Socks or stockings must be removed to obtain accurate data.

Question: Is it okay to wear accessories (jewelry, watch, rings, etc.) or metal objects while taking the InBody Test?

Answer: The ideal condition for the analysis is simply standing with no clothes and wearing no accessories. However, this may not always be possible. Therefore, we recommend that the examinee remove as many clothing items and accessories that may affect the weight as possible.

Question: Who cannot take the InBody Test or will have difficulties taking the InBody Test?

Answer:

- Individuals with medical implant devices, such as pacemakers or essential support devices, such as patient monitoring systems, must not use this equipment. The currents will flow through the body during the test, which may cause device malfunctioning or endanger lives.
- Children, amputees, or the elderly may have trouble testing if they cannot hold the hand electrodes or stand still on the foot electrodes.

Question: Can a person with metal implants in the body take the InBody Test?

Answer:

- The ideal test methodology is where the examinee does not wear anything metallic. Individuals with metallic implants may have skewed test results due to the conductivity of the metal affecting the results.
- As the weight of clothes and other wear affects the results of the body composition analysis, it is strongly recommended to take off any heavy clothing or metallic wear. Except for the weight, jewelry does not affect the body composition analysis, as the contact point with the InBody are hands and feet.

Question: I have limited mobility and cannot maintain proper posture for the InBody Test. How can I still be tested?

Answer: It is impossible to test if an individual cannot maintain contact with the hand or foot electrodes. InBody has a product line that conducts body composition analysis on bedridden examinees and allows the patients to stay in bed. For more information, please contact InBody.

Question: Is the electric current harmful to the body?

Answer: The physiological electric impedance method uses safe low-level currents that are not harmful to the body. The safety of the InBody has been tested and proven. The InBody products have been approved for medical use by the CE and worldwide. Many medical institutions around the world are actively using the InBody.

Question: How often should I take the InBody Test?

Answer:

- Individuals who are undergoing programs that may affect their body composition are strongly recommended to have the InBody Test done every two to four weeks.
- Consistent testing will allow individuals to track and monitor their progress.

Question: What are the precautionary steps to ensure accuracy of the InBody Test?

Answer: Please refer to "6.1 Precautions for Test" in section "6 InBody Test" in this User's Manual.

9 Classifications and Specifications

9.1 Classifications

Classifications	Body Composition Analyzer of Direct Segmental Multi-frequency Bioelectrical Impedance Analysis Method	
	Type of Protection against Electric Shock	Class I
	Type of the Applied Parts	BF Type
	EMC Emission	Class B
	Degree of Protection against Water Infiltration	IPX0

9.2 Specifications

Bioelectrical Impedance Analysis (BIA) Items	Bioelectrical Impedance (Z)	30 Impedance Measurements by Using 6 Different Frequencies (5 kHz, 50 kHz, 250 kHz, 500 kHz, 1 MHz, 3 MHz) at Each of the 5 segments (Right Arm, Left Arm, Trunk, Right Leg, and Left Leg)
	Phase Angle (\emptyset)	15 Phase Angle Measurement by Using 3 Different Frequencies (5 kHz, 50 kHz, 250 kHz) at Each of 5 Segments (Right Arm, Left Arm, Trunk, Right Leg, and Left Leg)
	Z0, Z ∞	At zero frequency, current does not pass through the cell membrane, so the impedance at zero frequency can be considered to reflect extracellular water, and at infinite frequency, the current can be seen to reflect both intracellular and extracellular water.
Electrode Method	Tetrapolar 8-Point Tactile Electrodes	
Measurement Method	Direct Segmental Multi-Frequency Bioelectrical Impedance Analysis (DSM-BIA) Simultaneous Multi-Frequency Bioelectrical Impedance Analysis (SMF-BIA)	
Body Composition Calculation	No Empirical Estimation (Age and sex does not affect the result)	

Outputs (Body Composition Result Sheet)	Results and Interpretation
<ul style="list-style-type: none"> • Body Composition Analysis (Total Body Water, Intracellular Water, Extracellular Water, Dry Lean Mass, Body Fat Mass, Fat Free Mass, Weight) • Muscle-Fat Analysis (Weight, Skeletal Muscle Mass, Body Fat Mass) • Obesity Analysis (Body Mass Index, Percent Body Fat) • Segmental Lean Analysis (Based on ideal weight/Based on current weight: Right Arm, Left Arm, Trunk, Right Leg, Left Leg) • Segmental Body Fat Analysis (Based on ideal weight/Based on current weight: Right Arm, Left Arm, Trunk, Right Leg, Left Leg) • ECW/TBW Analysis • Body Composition History (Weight, Skeletal Muscle Mass, Percent Body Fat, ECW/TBW) • InBody Score • Whole Body Phase Angle (History) • SMI (History) • Visceral Fat Area (Graph) • Body Fat-Fat Free Mass Control (Body Fat Mass, Fat Free Mass) • Nutrition Evaluation (Protein, Minerals, Body Fat) • Obesity Evaluation (BMI, PBF) • Body Balance Evaluation (Upper, Lower, Upper-Lower) • Segmental Fat Analysis (Right Arm, Left Arm, Trunk, Right Leg, Left Leg) • Body Water Composition (Total Body Water, Intracellular Water, Extracellular Water) • Segmental Body Water Analysis (Right Arm, Left Arm, Trunk, Right Leg, Left Leg) • Segmental ICW Analysis (Right Arm, Left Arm, Trunk, Right Leg, Left Leg) • Segmental ECW Analysis (Right Arm, Left Arm, Trunk, Right Leg, Left Leg) • Body Composition Analysis • Muscle-Fat Analysis • Obesity Analysis (BMI, PBF) • Research Parameters (Intracellular Water, Extracellular Water, Skeletal Muscle Mass, Fat Free Mass, Basal Metabolic Rate, Waist Circumference, Visceral Fat Level, Visceral Fat Area, Protein, Mineral, Bone Mineral Content, Body Fat Mass, Body Cell Mass, Arm Circumference, Leg Lean Mass, TBW/FFM, ICW/FFM, FFMI, FMI, SMI, SMM/WT, ECM/BCM, TBW/WT, Adjusted FFM, Adjusted SMI) • Recommended Calorie Intake Per Day • Calorie Expenditure of Exercise • Blood Pressure (Systolic, Diastolic, Pulse, Mean Artery Pressure, Pulse Pressure, Rate Pressure Product) • QR Code • Results Interpretation QR Code • Whole Body Phase Angle (50 kHz) • Segmental Phase Angle (5kHz, 50 kHz, 250kHz: Right Arm, Left Arm, Trunk, Right Leg, Left Leg) • BIVA (Bioelectrical Impedance Vector) • Impedance(Z0, Z∞) • Impedance Graph (Each segment and each frequency) 	

Classifications and Specifications

Outputs (Body Composition Result Sheet for Children)	Results and Interpretation <ul style="list-style-type: none"> • Body Composition Analysis (Total Body Water, Protein, Body Fat Mass, Weight) • Muscle-Fat Analysis (Weight, Skeletal Muscle Mass, Body Fat Mass) • Obesity Analysis (Body Mass Index, Percent Body Fat) • Growth Graph (Height, Weight, BMI) • Body Composition History (Height, Weight, Skeletal Muscle Mass, Percent Body Fat) • Whole Body Phase Angle (History) • SMI (History) • Body Fat-Fat Free Mass Control (Body Fat Mass, Fat Free Mass) • Nutrition Evaluation (Protein, Minerals, Body Fat) • Obesity Evaluation (BMI, PBF) • Body Balance Evaluation (Upper, Lower, Upper-Lower) • Segmental Lean Analysis (Right Arm, Left Arm, Trunk, Right Leg, Left Leg) • Segmental Body Water Analysis (Right Arm, Left Arm, Trunk, Right Leg, Left Leg) • Research Parameters (Intracellular Water, Extracellular Water, Skeletal Muscle Mass, Fat Free Mass, Basal Metabolic Rate, Protein, Mineral, Bone Mineral Content, Body Cell Mass, FFMI, FMI, SMI, SMM/WT, ECM/BCM, TBW/WT) • Blood Pressure (Systolic, Diastolic, Pulse, Mean Artery Pressure, Pulse Pressure, Rate Pressure Product) • QR code • Results Interpretation QR code • Whole Body Phase Angle (50kHz: the right side of the body) • Segmental Phase Angle (5kHz, 50kHz, 250kHz: Right Arm, Left Arm, Trunk, Right Leg, Left Leg) • Impedance Graph (Each segment and each frequency) 	Outputs (Body Water Result Sheet) Results and Interpretations <ul style="list-style-type: none"> • Body Water Composition (Total Body Water, Intracellular Water, Extracellular Water) • ECW/TBW Analysis • Segmental Body Water Analysis (Right Arm, Left Arm, Trunk, Right Leg, Left Leg) • Segmental ECW/TBW Analysis (Right Arm, Left Arm, Trunk, Right Leg, Left Leg) • Body Water Composition History (Weight, Total Body Water, Intracellular Water, Extracellular Water, ECW/TBW) • InBody Score • Whole Body Phase Angle (History) • SMI (History) • Visceral Fat Area (Graph), • Body Fat-Fat Free Mass Control (Body Fat Mass, Fat Free Mass) • Nutrition Evaluation (Protein, Minerals, Fat Mass) • Obesity Evaluation (BMI, PBF) • Body Balance Evaluation (Upper, Lower, Upper-Lower) • Segmental Fat Analysis (Right Arm, Left Arm, Trunk, Right Leg, Left Leg) • Body Water Composition (Total Body Water, Intracellular Water, Extracellular Water) • Segmental Body Water Analysis (Right Arm, Left Arm, Trunk, Right Leg, Left Leg) • Segmental ICW Analysis (Right Arm, Left Arm, Trunk, Right Leg, Left Leg) • Segmental ECW Analysis (Right Arm, Left Arm, Trunk, Right Leg, Left Leg) • Body Composition Analysis (Intracellular Water, Extracellular Water, Dry Lean Mass, Fat Free Mass, Body Fat Mass) • Muscle-Fat Analysis (Weight, Skeletal Muscle Mass, Body Fat Mass) • Obesity Analysis (Body Mass Index, Percent Body Fat) • Visceral Fat Level (Graph) • Research Parameters (Intracellular Water, Extracellular Water, Skeletal Muscle Mass, Fat Free Mass, Basal Metabolic Rate, Waist Circumference, Visceral Fat Level, Visceral Fat Area, Protein, Mineral, Bone Mineral Content, Body Fat Mass, Body Cell Mass, Arm Circumference, Leg Lean Mass, TBW/LBM, ICW/LBM, FFMI, FMI, SMI, SMM/WT, ECM/BCM, TBW/WT, Adjusted FFM, Adjusted SMI) • Recommended Calorie Intake Per Day • Calorie Expenditure of Exercise • Blood Pressure (Systolic, Diastolic, Pulse, Mean Artery Pressure, Pulse Pressure, Rate Pressure Product) • QR Code • Results Interpretation QR Code • Whole Body Phase Angle (50kHz: the right side of the body) • Segmental Phase Angle (5kHz, 50kHz, 250kHz: Right Arm, Left Arm, Trunk, Right Leg, Left Leg) • BIVA (Bioelectrical Impedance Vector) • Impedance(Z_0, Z_∞) • Impedance Graph (Each segment and each frequency)
---	--	---

Outputs (Research Result Sheet)	<ul style="list-style-type: none"> • Body Composition Summary (Fat Free Mass, Fat Mass, Intracellular Water, Extracellular Water, Total Body Water, ECW/TBW: Whole Body, Right Arm, Left Arm, Trunk, Right Leg, Left Leg, Whole Body Weight) • Body Composition Analysis (FFM-Lean, ICW, ECW, Fat Mass, ECW/TBW: Whole Body, Right Arm, Left Arm, Trunk, Right Leg, Left Leg) • Research Parameters (BMI, Percent Body Fat, Skeletal Muscle Mass, Soft Lean Mass, Protein, Minerals, Bone Mineral Content, Basal Metabolic Rate, Waist-Hip Ratio, Waist Circumference, Visceral Fat Area, Obesity Degree, Body Cell Mass, Arm Circumference, Arm Muscle Circumference, TBW/FFM, FFMI, FMI, SMI) • Whole Body Phase Angle (50 kHz) • Segmental Phase Angle (5 kHz, 50 kHz, 250 kHz: Right Arm, Left Arm, Trunk, Right Leg, Left Leg) • Impedance Graph (Each segment and each frequency)
Outputs (Comparison Result Sheet)	<ul style="list-style-type: none"> • Weight, Skeletal Muscle Mass, Body Fat Mass, ECW Ratio, Phase Angle: Whole Body (Today, Recent, Difference) • Lean Mass, ECW Ratio, Phase Angle: Right Arm, Left Arm, Trunk, Right Leg, Left Leg (Today, Recent, Difference) • Cole-Cole Plot (Current data, Previous data, Standard median curve)
Outputs (Evaluation Result Sheet)	<ul style="list-style-type: none"> • Bioelectrical Impedance Vector Analysis (BIVA) • Whole Body Phase Angle_50 kHz (PhA, \emptyset) (M \pm SD, Percentile Graph) • Segmental Phase Angle_50 kHz (PhA, \emptyset) Balance • Whole Body ECW Ratio (ECW/TBW) (M \pm SD, Percentile Graph) • ECW Ratio (ECW/TBW) Balance • TBW/WT(%) (M \pm SD, Percentile Graph) • Percent Body Fat (PBF, %) (M \pm SD, Percentile Graph) • Skeletal Muscle Mass and ECW Ratio (SMM, % & ECW/TBW) • Skeletal Muscle mass Index and ECW Ratio (SMI, kg/m² & ECW/TBW) • Skeletal Muscle mass Index (SMI, kg/m²) (M \pm SD, Percentile Graph) • Fat Free Mass Index (FFMI, kg/m²) (M \pm SD, Percentile Graph) • Lean Mass (LM) Balance • Fat Mass Index (FMI, kg/m²) (M \pm SD, Percentile Graph) • Skeletal Muscle Mass divided by WT (SMM/WT, %) (M \pm SD, Percentile Graph) • Visceral Fat Area (VFA, cm²) (M \pm SD, Percentile Graph) • Weight (kg) (M \pm SD, Percentile Graph) • Body Mass Index (BMI, kg/m²) (M \pm SD, Percentile Graph) • Body Cell Mass (BCM, kg) (M \pm SD, Percentile Graph) • ECM/BCM (M \pm SD, Percentile Graph)

Functional Specifications

Compatible Device	Stadiometer, Blood pressure monitor, InBodyBAND Series (starting provided by InBodyBAND), and InGrip provided by InBody
Logo Display	Name, Address and Content Information can be shown on the Result Sheet
Digital Results	LCD Screen, LookinBody Web, LookinBody
Types of Result Sheets	Body Composition Result Sheet, InBody Result Sheet for Children, Body Water Result Sheet, Evaluation Result Sheet, Research Result Sheet, Comparison Result Sheet, Body Composition Result Sheet for Children
Voice Guidance	Audible guidance for test in progress and test complete
Data Storage	Saves up to 100,000 measurements (when the ID is entered)
Administrator Menu	Setup: Configure settings and manage data. FAQ: Additional information to help with using the InBody.
USB Thumb Drive	Copy, backup, or restore the LookinBody test data (data can be viewed on Excel or LookinBody)
Barcode Reader	Member ID will be automatically inputted when the Barcode is scanned
InBodyBAND Series Recognition Function	Recognizes the InBodyBAND series of the subject and automatically inputs personal information to the InBody (starting provided by InBodyBAND)
Fingerprint Recognition Function	Recognizes the fingerprint of the measurer and automatically inputs personal information to the InBody
Backup Data	Backup data saved in InBody by using an InBody USB
QR code	By scanning QR codes, you can send and verify the InBody results.

* QR code is registered trademark of DENSO WAVE INCORPORATED.

* Blood pressure information can only be printed when the blood pressure monitor is connected.

Classifications and Specifications

Other Specifications



Applied Rating Current	300 μ A (\pm 30 μ A)		
Adapter	DELTA	Power Input	AC 100 - 240 V, 50 - 60 Hz, 1.5 A - 0.75 A
		Power Output	DC 12 V \equiv , 5.0 A
	Mean Well	Power Input	AC 100 - 240 V, 50 / 60 Hz, 1.0 A - 0.5 A
		Power Output	DC 12V \equiv , 3.34 A
Display Type	1280 \times 800 10.1 inch Color TFT LCD		
Internal Interface	Touchscreen, Keypad		
External Interface	RS-232C 4 EA, USB Host 2 EA, USB Slave 1 EA, LAN (10/100 T) 1 EA, Bluetooth 1 EA, Wi-Fi (2.4 G/5 G) 1 EA		
Compatible Printer	Laser/Inkjet PCL 3 or above and SPL		
Dimensions	24.2 (W) \times 37.9 (L) \times 48.8 (H): in 614.1 (W) \times 963.8 (L) \times 1239.3 (H): mm		
Device Weight	90.6 lb (41.1 kg)		
Test Duration	About 30 seconds		
Operation Environment	50 - 104 $^{\circ}$ F (10 - 40 $^{\circ}$ C), 30 - 75 % RH, 70 - 106 kPa		
Storage Environment	-4 - 158 $^{\circ}$ F (-20 - 70 $^{\circ}$ C), 10 - 95 % RH, 50 - 106 kPa (No condensation)		
Weight Range	4.4 - 661.4 lb (2 - 300 kg)		
Age Range	3+ years		
Height Range	3 ft 1.40 in - 7 ft 2.61 in (95 - 220 cm)		

* Specifications are subject to change without prior notice.





* This device is a medical device. Please read the WARNINGS and PRECAUTIONS before you use it.

9.3 Symbols Used on the Device





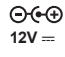

Indicators

	9-pin Serial Port (Female, RS-232C)
	LAN Port (10/100T Base)
	USB Port

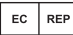
Safety Symbols

	High Voltage
	Warning, Caution
	BF Type Device
	Adapter
	Power On
	Power Off

Etc. Symbols

	Manufacturer
	Authorized Representative in the European Community
	Serial Number
	Direct Current
	Operating Instructions
	Unique Device Identification
	Do Not Disassemble, Adjust, or Repair the Product Arbitrarily
	Complies with AAMI ES60601-1 CSA-C22.2 No. 60601-1



Disposal of old Electrical & Electronic Devices
(Application in the European Union and other
European countries with separate collection
system.)

This symbol indicates that this device shall not be treated as household waste. Instead, it shall be handed over to the applicable collection point for the recycling of electrical and electronic devices. By ensuring this device is disposed of correctly, you will help prevent potential negative consequences for the environment and human health, which could otherwise be caused by inappropriate waste handling of this device. For more detailed information about recycling this device, please refer to local governing ordinances and recycling plans.

9.4 Guidance and Manufacturer's Declaration

The InBody device is intended for use in the electromagnetic environment specified below. The customer or the user of the InBody device should ensure that it is used in such an environment.

Electromagnetic Emissions

Emissions Test	Compliance	Electromagnetic Environment
RF emissions CISPR 11	Group 1	The InBody device uses RF energy only for its internal function. Therefore, its RF emissions are very low and are not likely to cause any interference in nearby electronic devices.
RF emissions CISPR 11	Class B	
Harmonic emissions IEC 61000-3-2	Class A	The InBody device is suitable for use in all establishments, including domestic establishments and those directly connected to the public low-voltage power supply network that supplies buildings used for domestic purposes.
Voltage fluctuations/ flicker emissions IEC 61000-3-3	Complies	

Electromagnetic Immunity

Immunity Test	IEC 60601 Test Level	Compliance Level	Electromagnetic Environment - Guidance
Electrostatic discharge IEC 61000-4-2	± 8 kV contact ± 2 kV, ± 4 kV, ± 8 kV, ± 15 kV air	± 8 kV contact ± 2 kV, ± 4 kV, ± 8 kV, ± 15 kV air	Floors should be wood, concrete or ceramic tile. If floors are covered with synthetic material, a relative humidity of at least 30 % is recommended.
Electrical fast transient/ burst IEC 61000-4-4	± 2 kV for power supply lines ± 1 kV for input/output lines	± 2 kV for power supply lines ± 1 kV for input/output lines	The main power quality should be that of a typical commercial or hospital environment.
Surge IEC 61000-4-5	± 0.5 kV, ± 1 kV differential mode ± 0.5 kV, ± 1 kV, ± 2 kV common mode	± 0.5 kV, ± 1 kV differential mode ± 0.5 kV, ± 1 kV, ± 2 kV common mode	The main power quality should be that of a typical commercial or hospital environment.
Voltage dips, short interruptions and voltage variations in power supply input lines IEC 61000-4-11	0 % Ut (100 % dip in Ut) for 0.5/1 cycles 70 % Ut (30 % dip in Ut) for 25/30 cycles 0 % Ut (100 % dip in Ut) for 250/300 cycles	0 % Ut (100 % dip in Ut) for 0.5/1 cycles 70 % Ut (30 % dip in Ut) for 25/30 cycles 0 % Ut (100 % dip in Ut) for 250/300 cycles	The main power quality should be that of a typical commercial or hospital environment. If the user of this device requires continued operation during power mains interruptions, it is recommended that this device be powered from an uninterruptible power supply or a battery.
Power frequency (50 / 60 Hz) magnetic field IEC 61000-4-8	30 A/m	30 A/m	Power frequency magnetic fields should be at levels characteristic of a commercial or hospital environment.

Recommended separation distances between portable and mobile communication devices and InBody device

The InBody device is intended for use in an electromagnetic environment in which radiated RF disturbances are controlled. The customer or the user of the InBody device can help prevent electromagnetic interference by maintaining a minimum distance between portable and mobile RF communications devices (transmitters) and the InBody device as recommended below, according to the maximum output power of the communications devices.

Rated maximum output power of the transmitter [W]	Separation distance according to frequency of transmitter [m]	
	IEC 60601-1-2: 2014	
	150 kHz to 80 MHz $d = 1.2\sqrt{P}$	80 MHz to 2.7 GHz $d = 2.0\sqrt{P}$
0.01	0.12	0.20
0.1	0.38	0.63
1	1.2	2.0
10	3.8	6.3
100	12	20

For transmitters rated at a maximum output power not listed above, the recommended separation distance d in meters (m) can be estimated using the equation applicable to the frequency of the transmitter, where P is the maximum output power rating of the transmitter in watts (W) according to the transmitter manufacturer.

NOTE 1 At 80 MHz and 800 MHz, the separation distance for the higher frequency range applies.

NOTE 2 These guidelines may not apply in all situations. Electromagnetic propagation is affected by absorption and reflection from structures, objects, and people.

Classifications and Specifications

Electromagnetic Immunity

Immunity Test	IEC 60601 Test Level	Compliance Level	Electromagnetic Environment - Guidance
Conducted RF IEC 61000-4-6	3 V 150 kHz to 80 MHz	3 V	Portable and mobile RF communications devices should not be used closer to any part of the Ultrasound System, including cables, than the recommended separation distance. This is calculated using the equation applicable to the frequency of the transmitter.
	6 Vrms 150 kHz – 80 MHz In ISM bands ¹ amateur radio bands Bands ²	6 V	Recommended separation distance $d = 1.2 \sqrt{P}$
Radiated RF IEC 61000-4-3	10 V/m 80 MHz to 2.7 GHz	10 V/m	IEC 60601-1-2:2014 $d = 2.0 \sqrt{P}$ 80 MHz to 2.7 GHz Where P is the maximum output power rating of the transmitter in watts (W) according to the transmitter manufacturer, and d is the recommended separation distance in meters (m). Field strengths from fixed RF transmitters, as determined by an electromagnetic site survey, ³ should be less than the compliance level in each frequency range. ⁴ Interference may occur in the vicinity of the device marked with the following symbol.



NOTE 1 At 80 MHz and 800 MHz, the higher frequency range applies.

NOTE 2 These guidelines may not apply in all situations. Electromagnetic propagation is affected by absorption and reflection from structures, objects and people.

1. The ISM (Industrial, Scientific and Medical) bands between 150 kHz and 80 MHz are 6.765 MHz to 6.795 MHz; 13.553 MHz to 13.567 MHz; 26.957 MHz to 27.283 MHz; and 40.66 MHz to 40.70 MHz.
2. The amateur radio bands between 0.15 MHz and 80 MHz are 1.8 MHz to 2.0 MHz, 3.5 MHz to 4.0 MHz, 5.3 MHz to 5.4 MHz, 7 MHz to 7.3 MHz, 10.1 MHz to 10.15 MHz, 14 MHz to 14.2 MHz, 18.07 MHz to 18.17 MHz, 21.0 MHz to 21.4 MHz, 24.89 MHz to 24.99 MHz, 28.0 MHz to 29.7 MHz and 50.0 MHz to 54.0 MHz.
3. Field strength from fixed transmitters, such as base stations for radio (cellular/cordless) telephones, land mobile radios, amateur radio, AM and FM radio broadcasts, and TV broadcasts, cannot be predicted theoretically with accuracy. To assess the electromagnetic environment due to fixed RF transmitters, an electromagnetic site survey should be considered. If the measured field strength in the location where the device is used exceeds the applicable RF compliance level, the device should be monitored to ensure normal operation. If abnormal performance is observed, additional measures may be necessary, such as reorienting or relocating the device.
4. When the frequency range exceeds 150 kHz to 80 MHz, the electric field strength should not exceed 3 V/m.

Electromagnetic Emissions

The InBody device is intended for use in an electromagnetic environment in which radiated RF disturbances are controlled. A portable RF communications devices should be used no closer than 30 cm (12 inches) to any part of the InBody device. Otherwise, the performance of this device could be impaired.

Immunity Test	Band	Service ⁵	Modulation ⁶	IEC60601 Test Level	Compliance Level
Proximity fields from RF wireless Communications IEC61000-4-3	380 - 390 MHz	TETRA 400	Pulse modulation 18 Hz	27 V/m	27 V/m
	430 - 470 MHz	GMRS 460 FRS 460	FM ⁷ ± 5 kHz deviation 1 kHz sine	28 V/m	28 V/m
	704 - 787 MHz	LTE Band 13, 17	Pulse modulation 217 Hz	9 V/m	9 V/m
	800 - 960 MHz	GSM800:900 TETRA 800 iDEN 820 CDMA 850 LTE Band 5	Pulse modulation 18 Hz	28 V/m	28 V/m
	1700 - 1990 MHz	GSM 1800 CDMA 1900 GSM 1900 DECT LTE Band 1,2,4,25 UMTS	Pulse modulation 217 Hz	28 V/m	28 V/m
	2400 - 2570 MHz	Bluetooth WLAN 802.11b/g/n RFID 2450 LTE Band	Pulse modulation 217 Hz	28 V/m	28 V/m
	5100 - 5800 MHz	WLAN 802.11a/n	Pulse modulation 217 Hz	9 V/m	9 V/m

NOTE If it is necessary to achieve the IMMUNITY TEST LEVEL, the distance between the transmitting antenna and the ME DEVICE or ME SYSTEM may be reduced to 1m. The 1m test distance is permitted by IEC 61000-4-3.

5. For some services, only the uplink frequencies are included.

6. The carrier shall be modulated using a 50 % duty cycle square wave signal.

7. As an alternative to FM modulation, 50 % pulse modulation at 18 Hz may be used because while it does not represent actual modulation, it would be the worst case.

Classifications and Specifications



Follow the instructions for use

Suivez les instructions d'utilisation



WARNING

- Electric shock hazard – Do not dismantle.
- Dismantling will void the warranty.
- Do not touch the signal input, signal output, or other connectors, and the patient simultaneously.
- External devices intended for connection to the signal input, signal output, or other connectors shall comply with the relevant IEC standards (e.g., IEC60950 for IT devices and the IEC60601-1 series for medical electrical devices). Additionally, all such combined systems must comply with the IEC60601-1 and/or IEC60601-1-1 harmonized national standards or their combination. If in doubt, contact a qualified technician or your local representative.



AVERTISSEMENT

- *Risque de choc électrique - ne pas démonter.*
- *Le démontage annulera la garantie.*
- *Ne touchez pas l'entrée de signal, la sortie de signal ou d'autres connecteurs et le patient simultanément.*
- *L'équipement externe destiné à être connecté à l'entrée de signal, à la sortie de signal ou à d'autres connecteurs doit être conforme à la norme IEC pertinente (par exemple, IEC60950 pour les équipements informatiques et la série IEC60601-1 pour les équipements électriques médicaux). De plus, tous ces systèmes combinés doivent être conformes à la norme nationale harmonisée IEC60601-1 et/ou IEC60601-1-1 ou à la combinaison. En cas de doute, contactez un technicien qualifié ou votre représentant local.*



DANGER

- Do not use this device with electrical medical devices such as pacemakers.
- *Ne pas utiliser cet appareil avec des dispositifs médicaux électroniques tels que les pacemakers.*



CAUTION

- Do not spray any liquid substance directly onto the device.
- *Ne pulvérisez aucune substances liquides directement sur l'appareil.*



CAUTION

- Avoid applying excessive force to the shoulder joint.
- *Ne pulvérisiez aucun liquide directement sur l'appareil.*

